

# Microwave Oven

## **INSTRUCTION MANUAL**

### **MODEL:MMO25XHA**

**Read these instructions carefully before using your microwave oven, and keep it carefully.**

If you follow the instructions, your oven will provide you with many years of good service.

### **SAVE THESE INSTRUCTIONS CAREFULLY**

Guangdong Midea Kitchen Appliances Manufacturing Co., Ltd.  
No.6, Yong An Road, Beijiao, Shunde, 528311 Foshan,  
Guangdong, People's Republic of China

[www.midea.com](http://www.midea.com)

# PRECAUTIONS TO AVOID POSSIBLE EXPOSURE TO EXCESSIVE MICROWAVE ENERGY

(a) Do not attempt to operate this oven with the door open since this can result in harmful exposure to microwave energy. It is important not to break or tamper with the safety interlocks.

(b) Do not place any object between the oven front face and the door or allow soil or cleaner residue to accumulate on sealing surfaces.

(c) **WARNING:** If the door or door seals are damaged, the oven must not be operated until it has been repaired by a competent person.

## ADDENDUM

If the apparatus is not maintained in a good state of cleanliness, its surface could be degraded and affect the lifespan of the apparatus and lead to a dangerous situation.

## Specifications

Model	MMO25XHA
Rated Voltage	220-240 V~ 50 Hz
Microwave Input	1550 W
Microwave Output	1000 W
Rated Input Convection/Airfry	2000-2350 W
Rated Input Grill	1600-1800 W
Rated Input Steam	1850-2150 W
Microwave Frequency	2450 MHz
2.4G WIFI	2412-2472 MHz
2.4G WIFI Transmit Power	< 20 dBm

# **IMPORTANT SAFETY INSTRUCTIONS**

## **WARNING**

To reduce the risk of fire, electric shock, injury to persons or exposure to excessive microwave oven energy when using your appliance, follow basic precautions, including the following:

1. Read and follow the specific: "PRECAUTIONS TO AVOID POSSIBLE EXPOSURE TO EXCESSIVE MICROWAVE ENERGY".
2. This appliance can be used by children aged from 8 years and above and persons with reduced physical, sensory or mental capabilities or lack of experience and knowledge if they have been given supervision or instruction concerning use of the appliance in a safe way and understand the hazards involved. Children shall not play with the appliance. Cleaning and user maintenance shall not be made by children unless they are older than 8 and supervised. Children less than 8 years of age shall be kept away unless continuously supervised.
3. Keep the appliance and its cord out of reach of children less than 8 years.
4. If the supply cord is damaged, it must be replaced by the manufacturer, its service agent or similarly qualified persons in order to avoid a hazard. ( For appliance with type Y attachment)
5. **WARNING:** Ensure that the appliance is switched off before replacing the lamp to avoid the possibility of electric shock.

6. WARNING: It is hazardous for anyone other than a competent person to carry out any service or repair operation that involves the removal of a cover which gives protection against exposure to microwave energy.
7. WARNING: Liquids and other foods must not be heated in sealed containers since they are liable to explode.
8. When heating food in plastic or paper containers, keep an eye on the oven due to the possibility of ignition.
9. Only use utensils that are suitable for use in microwave ovens.
10. If smoke is emitted, switch off or unplug the appliance and keep the door closed in order to stifle any flames.
11. Microwave heating of beverages can result in delayed eruptive boiling, therefore care must be taken when handling the container.
12. The contents of feeding bottles and baby food jars shall be stirred or shaken and the temperature checked before consumption, in order to avoid burns.
13. Eggs in their shell and whole hard-boiled eggs should not be heated in microwave ovens since they may explode, even after microwave heating has ended.
14. The oven should be cleaned regularly and any food deposits removed.
15. Failure to maintain the oven in a clean condition could lead to deterioration of the surface that could adversely affect the life of the appliance and possibly result in a hazardous situation.

16. The appliance must not be installed behind a decorative door in order to avoid overheating. (This is not applicable for appliances with decorative door.)

17. Only use the temperature probe recommended for this oven. (for ovens provided with a facility to use a temperature-sensing probe.)

18. The microwave oven shall not be placed in a cabinet unless it has been tested in a cabinet.

19. This appliance is intended to be used in household and similar applications such as:

- staff kitchen areas in shops, offices and other working environments;
- by clients in hotels, motels and other residential type environments;
- farm houses;
- bed and breakfast type environments.

20. The microwave oven is intended for heating food and beverages. Drying of food or clothing and heating of warming pads, slippers, sponges, damp cloth and similar may lead to risk of injury, ignition or fire.

21. Metallic containers for food and beverages are not allowed during microwave cooking.

22. The appliance shall not be cleaned with a steam cleaner.

23. The appliance is intended to be used freestanding.

24. The rear surface of appliances shall be placed against a wall.

25. Steam cleaner is not to be used.
26. Surface of a storage drawer can get hot.
27. Do not use harsh abrasive cleaners or sharp metal scrapers to clean the oven door glass since they can scratch the surface, which may result in shattering of the glass.
28. **WARNING:** The appliance and its accessible parts become hot during use. Care should be taken to avoid touching heating elements. Children less than 8 years of age shall be kept away unless continuously supervised.
29. During use the appliance becomes hot. Care should be taken to avoid touching heating elements inside the oven.
30. **WARNING:** Accessible parts may become hot during use. Young children should be kept away.
31. **WARNING:** When the appliance is operated in the combination mode, children should only use the oven under adult supervision due to the temperatures generated.
32. Appliances are not intended to be operated by means of an external timer or separate remote-control system.

**READ CAREFULLY AND KEEP FOR FUTURE REFERENCE**

# To Reduce the Risk of Injury to Persons Grounding Installation

## **DANGER**

Electric Shock Hazard  
Touching some of the internal components can cause serious personal injury or death. Do not disassemble this appliance.

## **WARNING**

Electric Shock Hazard  
Improper use of the grounding can result in electric shock. Do not plug into an outlet until appliance is properly installed and grounded.

This appliance must be grounded. In the event of an electrical short circuit, grounding reduces the risk of electric shock by providing an escape wire for the electric current. This appliance is equipped with a cord having a grounding wire with a grounding plug. The plug must be plugged into an outlet that is properly installed and grounded.

Consult a qualified electrician or serviceman if the grounding instructions are not completely understood or if doubt exists as to whether the appliance is properly grounded. If it is necessary to use an extension cord, use only a 3-wire extension cord.

1. A short power-supply cord is provided to reduce the risks resulting from becoming entangled in or tripping over a longer cord.
2. If a long cord set or extension cord is used:
  - 1)The marked electrical rating of the cord set or extension cord should be at least as great as the electrical rating of the appliance.
  - 2)The extension cord must be a grounding-type 3-wire cord.
  - 3)The long cord should be arranged so that it will not drape over the counter top or tabletop where it can be pulled on by children or tripped over unintentionally.

## CLEANING

Be sure to unplug the appliance from the power supply.

1. Clean the cavity of the oven after using with a slightly damp cloth.
2. Clean the accessories in the usual way in soapy water.
3. The door frame and seal and neighbouring parts must be cleaned carefully with a damp cloth when they are dirty.
4. Do not use harsh abrasive cleaners or sharp metal scrapers to clean the oven door glass since they can scratch the surface, which may result in shattering of the glass.
5. Cleaning Tip---For easier cleaning of the cavity walls that the food cooked can touch: Place half a lemon in a bowl, add 300ml (1/2 pint) water and heat on 100% microwave power for 10 minutes. Wipe the oven clean using a soft, dry cloth.

## UTENSILS

### CAUTION

#### Personal Injury Hazard

It is hazardous for anyone other than a competent person to carry out any service or repair operation that involves the removal of a cover which gives protection against exposure to microwave energy.

See the instructions on "Materials you can use in microwave oven or to be avoided in microwave oven."

There may be certain non-metallic utensils that are not safe to use for microwaving. If in doubt, you can test the utensil in question following the procedure below.

Utensil Test:

1. Fill a microwave-safe container with 1 cup of cold water (250ml) along with the utensil in question.
2. Cook on maximum power for 1 minute.
3. Carefully feel the utensil. If the empty utensil is warm, do not use it for microwave cooking.
4. Do not exceed 1 minute cooking time.



## Materials you can use in microwave oven

Utensils	Remarks
Browning dish	Follow manufacturer's instructions. The bottom of browning dish must be at least 3/16 inch (5mm) above the turntable. Incorrect usage may cause the turntable to break.
Dinnerware	Microwave-safe only. Follow manufacturer's instructions. Do not use cracked or chipped dishes.
Glass jars	Always remove lid. Use only to heat food until just warm. Most glass jars are not heat resistant and may break.
Glassware	Heat-resistant oven glassware only. Make sure there is no metallic trim. Do not use cracked or chipped dishes.
Oven cooking bags	Follow manufacturer's instructions. Do not close with metal tie. Make slits to allow steam to escape.
Paper plates and cups	Use for short-term cooking/warming only. Do not leave oven unattended while cooking.
Paper towels	Use to cover food for reheating and absorbing fat. Use with supervision for a short-term cooking only.
Parchment paper	Use as a cover to prevent splattering or a wrap for steaming.
Plastic	Microwave-safe only. Follow the manufacturer's instructions. Should be labeled "Microwave Safe". Some plastic containers soften, as the food inside gets hot. "Boiling bags" and tightly closed plastic bags should be slit, pierced or vented as directed by package.
Plastic wrap	Microwave-safe only. Use to cover food during cooking to retain moisture. Do not allow plastic wrap to touch food.
Thermometers	Microwave-safe only (meat and candy thermometers).
Wax paper	Use as a cover to prevent splattering and retain moisture.

## Materials to be avoided in microwave oven

Utensils	Remarks
Aluminum tray	May cause arcing. Transfer food into microwave-safe dish.
Food carton with metal handle	May cause arcing. Transfer food into microwave-safe dish.
Metal or metal-trimmed utensils	Metal shields the food from microwave energy. Metal trim may cause arcing.
Metal twist ties	May cause arcing and could cause a fire in the oven.
Paper bags	May cause a fire in the oven.
Plastic foam	Plastic foam may melt or contaminate the liquid inside when exposed to high temperature.
Wood	Wood will dry out when used in the microwave oven and may split or crack.

# NAMES OF OVEN PARTS AND ACCESSORIES

(In case of any differences between the appliance and the pictures in this manual, the product shall prevail.)

Remove the oven and all materials from the carton and oven cavity. Your oven comes with the following accessories:

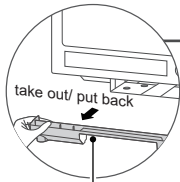
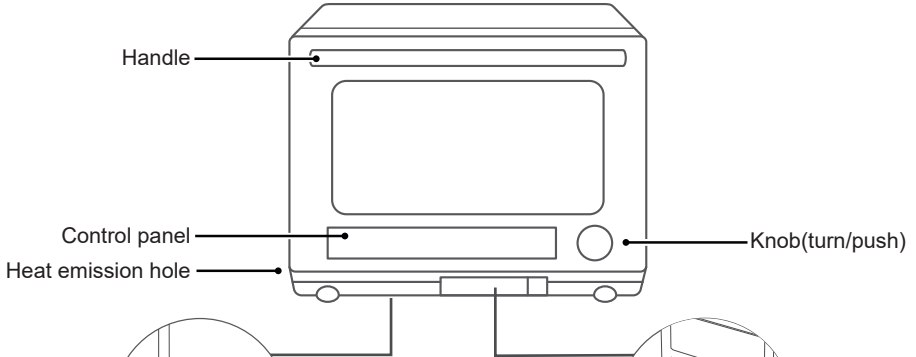

**Drip collector**  
 (Use for catching the water dripping from the cavity).  
 Note: Please dump the dirty water after cooking.

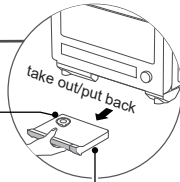

The position for add purified water  
**purified water box**  
 (Fill the box of purified water(<math><40\text{ }^{\circ}\text{C}</math>) before steam and cleaning function).

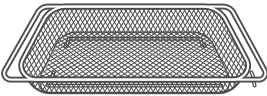

**Airfry basket**

(Can't be used in steam and microwave cooking)

Place in the cavity slot, use for Airfry cooking.

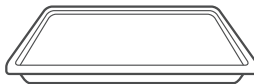

**Bake tray**

(Can't be used in microwave cooking)

Place in the cavity slot, bake oily food or take food residue.

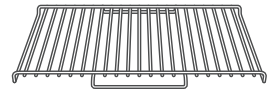

**Grill rack**

(Can't be used in microwave cooking)

Place on the cavity or on the bake tray, use for grill, bake and steam cooking.

**Notes:**

Airfry basket: Perforated to contain vegetables.

Bake tray: Designed to contain liquids.

# Countertop Installation

Remove all packing material and accessories. Examine the oven for any damage such as dents or broken door. Do not install if oven is damaged.

Cabinet: Remove any protective film found on the microwave oven cabinet surface.

## Installation

1. Select a level surface that provide enough open space for the intake and/or outlet vents.

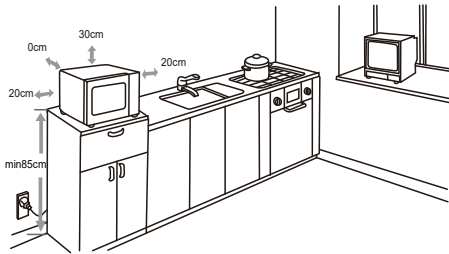

(1) The minimum installation height is 85cm.

(2) The rear surface of appliance shall be placed against a wall.

Leave a minimum clearance of 30cm above the oven, a minimum clearance of 20cm is required between the oven and any adjacent walls.

(3) Do not remove the legs from the bottom of the oven.

(4) Blocking the intake and/or outlet openings can damage the oven.

(5) Place the oven as far away from radios and TV as possible. Operation of microwave oven may cause interference to your radio or TV reception.

2. Plug your oven into a standard household outlet. Be sure the voltage and the frequency is the same as the voltage and the frequency on the rating label.

**WARNING:** Do not install oven over a range cooktop or other heat-producing appliance. If installed near or over a heat source, the oven could be damaged and the warranty would be void.

The accessible surface may be hot during operation.



# OPERATION INSTRUCTION

## SPEEDY COOKING

In standby mode, press “CONFIRM/START” to start microwave cooking for 30 seconds with 100% power level directly.

## MICROWAVE FUNCTION

- (1) In standby mode, press “MICRO.” once to enter microwave function, the default time is 30 seconds.
- (2) Turn the knob to set the power level, 1000W, 800W, 500W, 300W, 100W are available.
- (3) Press “CONFIRM/START” to confirm.
- (4) Turn the knob to set the cooking time, the maximum value is 90 minutes.
- (5) Press “CONFIRM/START” to start cooking.

## AIRFRY WITHOUT PREHEAT

- (1) In standby mode, press “AIR-FRY” once, the default temperature 180°C will display.
- (2) Turn the knob to set the temperature, 100°C-230°C are available.
- (3) Press “CONFIRM/START” to confirm.
- (4) Turn the knob to set the cooking time, the maximum value is 90 minutes.
- (5) Press “CONFIRM/START” to start cooking.

## AIRFRY WITH PREHEAT

- (1) In standby mode, press "AIR-FRY" twice, the default temperature 180°C will display.
- (2) Turn the knob to set the temperature, 100°C-230°C are available.
- (3) Press "CONFIRM/START" to start preheating. When the preheating temperature has arrived, put the food into the oven, then close the door.
- (4) Turn the knob to set the cooking time, the maximum value is 90 minutes.
- (5) Press "CONFIRM/START" to start cooking.

## GRILL WITHOUT PREHEAT

- (1) In standby mode, press "GRILL+STEAM" once, the default temperature 220°C will display.
- (2) Turn the knob to set the temperature, 100°C-230°C are available.
- (3) Press "CONFIRM/START" to confirm.
- (4) Turn the knob to set the cooking time, the maximum value is 90 minutes.
- (5) Press "CONFIRM/START" to start cooking.

## GRILL WITH PREHEAT

- (1) In standby mode, press "GRILL+STEAM" twice, the default temperature 220°C will display.
- (2) Turn the knob to set the temperature, 100°C-230°C are available.
- (3) Press "CONFIRM/START" to start preheating. When the preheating temperature has arrived, put the food into the oven, then close the door.
- (4) Turn the knob to set the cooking time, the maximum value is 90 minutes.
- (5) Press "CONFIRM/START" to start cooking.

## BAKE WITHOUT PREHEAT

- (1) In standby mode, press “BAKE” once, the default temperature 150°C will display.
- (2) Turn the knob to set the temperature, 100°C-230°C are available.
- (3) Press “CONFIRM/START” to confirm.
- (4) Turn the knob to set the cooking time, the maximum value is 90 minutes.
- (5) Press “CONFIRM/START” to start cooking.

## BAKE WITH PREHEAT

- (1) In standby mode, press “BAKE” twice, the default temperature 150°C will display.
- (2) Turn the knob to set the temperature, 100°C-230°C are available.
- (3) Press “CONFIRM/START” to start preheating. When the preheating temperature has arrived, put the food into the oven, then close the door.
- (4) Turn the knob to set the cooking time, the maximum value is 90 minutes.
- (5) Press “CONFIRM/START” to start cooking.

## STEAM

- (1) In standby mode, press “STEAM” once, the default temperature 100°C will display.
- (2) Turn the knob to set the temperature, 50°C-130°C are available.
- (3) Press “CONFIRM/START” to confirm .
- (4) Turn the knob to set the cooking time, the maximum value is 90 minutes.
- (5) Press “CONFIRM/START” to start cooking.

### Notes:

- (1) After steam cooking has finished, remove the water from the cavity and the door pane.
- (2) Empty the purified water box after steam cooking.

## AUTO MENU

- (1) In standby mode, press “AUTO MENU” once, 01 will display.
- (2) Turn the knob to choose the desired menu, 52 menus are available.
- (3) Press “CONFIRM/START” to confirm.
- (4) Turn the knob to set the cooking time.
- (5) Press “CONFIRM/START” to start cooking.

### Auto Menu chart

NUMBER	AUTO MENU	WEIGHT/AMOUNT
01	Chicken Thigh with Honey Sauce	900g
02	Baked Sweet Potato	1000g
03	Baked Shrimp with Spiced Salt	400g
04	Grilled Sausage	300g
05	French Fries	500g
06	Chicken Fillets	350g
07	Crispy Meat	350g
08	Chicken Nuggets	500g
09	Honey Chestnuts	500g
10	Peanuts	300g
11	Shrimp Tempura	400g
12	Japanese Gillette Tonkatsu	500g
13	Grilled Smelts	250g
14	Crispy Shrimp Balls with Milk and Oats	200g
15	Orleans Roasted Chicken Wing	500g
16	Garlic Spare Ribs	400g
17	Grilled Squid with Sauce	800g
18	Low Salt Salmon	200g
19	Low-Fat Roasted bacon	200g

NUMBER	AUTO MENU	WEIGHT/AMOUNT
20	Crispy Char Siew	500g
21	Steamed Sea Bass	400g
22	Steamed Frozen Buns	500g
23	Steamed Egg Custard	300g
24	Steamed Ribs	400g
25	Steamed Clams with Black Bean and Pepper	400g
26	Steamed Baby Vegetables with Garlic	400g
27	Steamed Shredded Eggplant	500g
28	Steamed Loofah with Minced Meat	500g
29	Steamed Broccoli	300g
30	Steamed Rice with Coarse Cereals	500g
31	Tremella Lotus Seed Soup	945g
32	Milk Papaya	1000g
33	Candy Sydney Drink	1540g
34	Taro and Sago	820g
35	Black Chicken Soup with Red Dates	1200g
36	Ribs Soup with Cordyceps Flower	1500g
37	Portuguese Egg Tart	9 pcs
38	Chiffon Cake	8 inch
39	Cranberry Cookies	12 pcs
40	Margarita Cookies	12 pcs
41	Italian Pizza	600g
42	Whole Wheat Bread	600g
43	Strawberry Muffin	8 pcs
44	Orange Madeleines	180g



NUMBER	AUTO MENU	WEIGHT/AMOUNT
45	Defrost	/
46	Ferment	/
47	Keep Warm	/
48	Cavity Deodorization	Note:After cooking the food,it is necessary to remove the residual odor in the cavity.
49	Cavity Cleaning	Note:Cleaning the cavity at regular to lengthen its service life.
50	Limescale Cleaning	/
51	Disinfection	/
52	Cavity Drying	/

## MORE FUNCTIONS

### Defrost by Weight

- (1) In standby mode, press "AUTO MENU" once, 01 will display.
- (2) Turn the knob left to choose the menu 45, "45" will display.
- (3) Press "CONFIRM/START" to confirm.
- (4) Turn the knob to set the weight within 100~1500 g.
- (5) Press "CONFIRM/START" to start defrosting.

Note: The buzzer will sound to remind of turning over the food during defrosting.

### Ferment

- (1) In standby mode, press "AUTO MENU" once, 01 will display.
- (2) Turn the knob left to choose the menu 46, "46" will display.
- (3) Press "CONFIRM/START" to confirm.
- (4) Turn the knob to set the temperature within 25°C-45°C.
- (5) Press "CONFIRM/START" to confirm.
- (6) Turn the knob to set the cooking time, the maximum value is 12 hours.
- (7) Press "CONFIRM/START" to start cooking.

### Keep Warm / Cavity Deodorization

- (1) In standby mode, press "AUTO MENU" once, 01 will display.
- (2) Turn the knob left to choose the menu 47/48.
- (3) Press "CONFIRM/START" to confirm.
- (4) Turn the knob to set the time.
- (5) Press "CONFIRM/START" to start.

### Notes:

- (1) Keep warm, to keep the food warm after cooking.
- (2) Cavity Deodorization, to remove the odor of the oven, the oven will work with fan.

## Cavity Cleaning

Cleaning the cavity regularly to lengthen its service life.

- (1) In standby mode, press "AUTO MENU" once, 01 will display.
- (2) Turn the knob left to choose the menu 49, "49" will display.
- (3) Press "CONFIRM/START" to confirm.
- (4) Turn the knob to set the time.
- (5) Press "CONFIRM/START" to start cleaning.

Notes:

- (1) Fill the purified water box with purified water before cleaning.
- (2) This function will use steam to soften the stains in the cavity for easy cleaning, after the end of the cleaning need to clean out the stains with a rag.

## Limescale Cleaning

- (1) In standby mode, press "AUTO MENU" once, 01 will display.
- (2) Turn the knob left to choose the menu 50, "50" will display.
- (3) Press "CONFIRM/START" to start cleaning.

Note:

Please add citric acid and purified water in the purified water box, after the completion of cleaning, refill purified water to clean the water pipe before use.

## Disinfection

Uncover the rubber lid, add a proper amount of purified water, cover the rubber lid and ensure good fitting. Then put all utensils on the grill rack.

- (1) In standby mode, press "AUTO MENU" once, 01 will display.
- (2) Turn the knob left to choose the menu 51, "51" will display.
- (3) Press "CONFIRM/START" to confirm.
- (4) Turn the knob to set the time.
- (5) Press "CONFIRM/START" to start.

## Cavity Drying

Heat to dry the water from the cavity and the door pane.

- (1) In standby mode, press "AUTO MENU" once, 01 will display.
- (2) Turn the knob left to choose the menu 52, "52" will display.
- (3) Press "CONFIRM/START" to confirm.
- (4) Turn the knob to set the time.
- (5) Press "CONFIRM/START" to start drying.

## WIRELESS CONNECTION

### Connect the network

In standby mode, press and hold "STOP/CANCEL" for 3 seconds, the wifi icon will flash slowly during wireless connection, if it connected successfully, wifi icon will keep light. If it fails, "AP" will display, wifi icon will light off, the oven will return to standby mode after 30 seconds.

### Disconnect from the network

In standby mode, press and hold "STOP/CANCEL" for 8 seconds, "----" will flash during disconnection, if the link has been removed successfully, "8888" will display and return to standby mode after 3 seconds. If it fails, "FFFF" will display, the oven will return to standby mode after 3 seconds.

Importer: MD (SINGAPORE) CONSUMER PRODUCT CO. PTE. LTD.  
Address: 151 Lor Chuan, #04-05 (Lobby E), New Tech Park, Singapore 556741

# Trouble shooting

Normal	
Microwave oven interfering TV reception	Radio and TV reception may be interfered when microwave oven operating. It is similar to the interference of small electrical appliances, like mixer, vacuum cleaner, and electric fan. It is normal.
Dim oven light	In low power microwave cooking, oven light may become dim. It is normal.
Steam accumulating on door, hot air out of vents	In cooking, steam may come out of food. Most will get out from vents. But some may accumulate on cool place like oven door. It is normal.
Oven started accidentally with no food in.	It is forbidden to run the unit without any food inside. It is very dangerous.

Trouble	Possible Cause	Remedy
Oven cannot be started.	(1) Power cord is not plugged in tightly.	Unplug. Then plug again after 10 seconds.
	(2) Fuse blowing or circuit breaker works.	Replace fuse or reset circuit breaker (repaired by professional personnel of our company)
	(3) Trouble with outlet.	Test outlet with other electrical appliances.
Oven does not heat.	(4) Door is not closed well.	Close door well.



According to Waste of Electrical and Electronic Equipment (WEEE) directive, WEEE should be separately collected and treated. If at any time in future you need to dispose of this product please do NOT dispose of this product with household waste. Please send this product to WEEE collecting points where available.

## RED Declaration of Conformity (DoC)

Hereby, [Guangdong Midea Kitchen Appliances Manufacturing Co., Ltd.], declares that this [TR023X2ZE-SS0F00] is in compliance with the essential requirements and other relevant provisions of RED Directive 2014/53/EU. A copy of the full DoC is attached.



# RED Declaration of Conformity (DoC)

Unique identification of this DoC: .....

**We,**

Guangdong Midea Kitchen Appliances Manufacturing Co.,Ltd.  
No.6,Yong An Road,Beijiao,Shunde 528311 Foshan,Guangdong PEOPLE'S REPUBLIC OF CHINA.

### declare under our sole responsibility that the product:

product name: Microwave Oven  
trade name: Midea  
type or model: TR023X2ZE-SS0F00  
relevant supplementary information: .....  
(e.g. lot, batch or serial number, sources and numbers of items)

**to which this declaration relates is in conformity with the essential requirements and other relevant requirements of the RE Directive (2014/53/EU).**

**The product is in conformity with the following standards and/or other normative documents:**

HEALTH & SAFETY (Art. 3(1)(a)): EN 62311:2008, EN IEC 62311:2020,  
EN 60335-1:2012/A15:2021, EN IEC 60335-2-25:2021/A11:2021,  
EN 60335-2-6:2015/A11:2020, EN 62233:2008

EMC (Art. 3(1)(b)): EN 301 489-1 V2.2.3:2019, EN 301 489-17 V3.2.4:2020,  
EN IEC 61000-3-2:2019/A1:2021, EN 61000-3-3:2013/A2:2021, EN IEC 55014-1:2021,  
EN IEC 55014-2:2021, EN 55011:2016/A2:2021

SPECTRUM (Art. 3(2)): EN 300 328 V2.2.2 (2019-07)

OTHER (incl. Art. 3(3) and voluntary specs): .....  
(title and/or number and date of issue of the standard(s) or other normative document(s))

Limitation of validity (if any): .....

Supplementary information:

Notified body involved: N/A.....

Technical file held by: Guangdong Midea Kitchen Appliances Manufacturing Co.,Ltd.

Place and date of issue (of this DoC): . 2023108-28 .....

Signed by or for the manufacturer: .....

Name (in print):.....

Title:.....

