

## MICROWAVE OVEN

# USER MANUAL

MMO25PFA-ACSF BK



SmartHome



Download the app  
& activate product

Warning notices: Before using this product, please read this manual carefully and keep it for future reference. The design and specifications are subject to change without prior notice for product improvement. Consult with your dealer or manufacturer for details.

The diagram above is just for reference. Please take the appearance of the actual product as the standard.

## THANK YOU LETTER

Thank you for choosing Midea! Before using your new Midea product, please read this manual thoroughly to ensure that you know how to operate the features and functions that your new appliance offers in a safe way.

# CONTENTS

THANK YOU LETTER	EN-01
SAFETY INSTRUCTIONS	EN-02
SPECIFICATION	EN-11
PRODUCT OVERVIEW	EN-12
PRODUCT INSTALLATION	EN-13
OPERATION INSTRUCTIONS	EN-15
APP SETUP AND OPERATION	EN-25
CLEANING AND MAINTENANCE	EN-26
TROUBLE SHOOTING	EN-27
TRADEMARKS, COPYRIGHTS AND LEGAL STATEMENT	EN-28
DATA PROTECTION NOTICE	EN-29

# SAFETY INSTRUCTIONS

## Intended Use

The following safety guidelines are intended to prevent unforeseen risks or damage from unsafe or incorrect operation of the appliance. Please check the packaging and appliance on arrival to make sure everything is intact to ensure safe operation. If you find any damage, please contact the retailer or dealer. Please note modifications or alterations to the appliance are not allowed for your safety concern. Unintended use may cause hazards and loss of warranty claims.

## Explanation of Symbols



### **Danger**

This symbol indicates that there are dangers to the life and health of persons due to extremely flammable gas.



### **Warning of electrical voltage**

This symbol indicates that there is a danger to life and health of persons due to voltage.



### **Warning**

The signal word indicates a hazard with a medium level of risk which, if not avoided, may result in death or serious injury.



### **Caution**

The signal word indicates a hazard with a low degree of risk which, if not avoided, may result in minor or moderate injury.



### **Attention**

The signal word indicates important information (e.g. damage to property), but not danger.



### **Observe instructions**

This symbol indicates that a service technician should only operate and maintain this appliance in accordance with the operating instructions.

Read these operating instructions carefully and attentively before using/commissioning the unit and keep them in the immediate vicinity of the installation site or unit for later use!

## **Precautions To Avoid Possible Exposure To Excessive Microwave Energy**

- a. Do not attempt to operate this oven with the door open since open door operation can result in harmful exposure to microwave energy.  
It is important not to defeat or tamper with the safety interlocks.
- b. Do not place any object between the oven front face and the door or allow soil or cleaner residue to accumulate on sealing surfaces.
- c. Do not operate the oven if it is damaged. It is particularly important that the oven door closes properly and that there is no damage to the:
  - DOOR (bent)
  - HINGES AND LATCHES (broken or loosened)
  - DOOR SEALS AND SEALING SURFACES
- d. The oven should not be adjusted or repaired by anyone except properly qualified service personnel.

## **Addendum**

If the apparatus is not maintained in a good state of cleanliness, its surface could be degraded and affect the lifespan of the apparatus and lead to a dangerous situation.



## Important Safety Instructions

To reduce the risk of fire, electric shock, injury to persons or exposure to excessive microwave oven energy when using your appliance, follow basic precautions, including the following:

### **▲ WARNING**

- Read and follow the specific: "PRECAUTIONS TO AVOID POSSIBLE EXPOSURE TO EXCESSIVE MICROWAVE ENERGY".
- This appliance is not intended for use by persons (including children) with reduced physical, sensory or mental capabilities, or lack of experience and knowledge, unless they have been given supervision or instruction concerning use of the appliance by a person responsible for their safety.
- Children should be supervised to ensure that they do not play with the appliance.
- If the supply cord is damaged, it must be replaced by the manufacturer, its service agent or similarly qualified persons in order to avoid a hazard.
- **WARNING:** Ensure that the appliance is switched off before replacing the lamp to avoid the possibility of electric shock.
- **WARNING:** It is hazardous for anyone other than a competent person to carry out any service or repair operation that involves the removal of a cover which gives protection against exposure to microwave energy.
- **WARNING:** Liquids and other foods must not be heated in sealed containers since they are liable to explode.

- When heating food in plastic or paper containers, keep an eye on the oven due to the possibility of ignition.
- Only use utensils that are suitable for use in microwave ovens.
- If smoke is emitted, switch off or unplug the appliance and keep the door closed in order to stifle any flames.
- Microwave heating of beverages can result in delayed eruptive boiling, therefore care must be taken when handling the container.
- The contents of feeding bottles and baby food jars shall be stirred or shaken and the temperature checked before consumption, in order to avoid burns.
- Eggs in their shell and whole hard-boiled eggs should not be heated in microwave ovens since they may explode, even after microwave heating has ended.
- The oven should be cleaned regularly and any food deposits removed.
- Failure to maintain the oven in a clean condition could lead to deterioration of the surface that could adversely affect the life of the appliance and possibly result in a hazardous situation.
- The appliance must not be installed behind a decorative door in order to avoid overheating. (This is not applicable for appliances with decorative door.)
- Only use the temperature probe recommended for this oven. (for ovens provided with a facility to use a temperature-sensing probe.)
- The microwave oven shall not be placed in a cabinet unless it has been tested in a cabinet.
- The microwave oven must be operated with the decorative door open. (for ovens with a decorative door.)

- This appliance is intended to be used in household and similar applications such as:
  - staff kitchen areas in shops, offices and other working environments;
  - by clients in hotels, motels and other residential type environments;
  - farm houses;
  - bed and breakfast type environments.
- The microwave oven is intended for heating food and beverages. Drying of food or clothing and heating of warming pads, slippers, sponges, damp cloth and similar may lead to risk of injury, ignition or fire.
- Metallic containers for food and beverages are not allowed during microwave cooking.
- The appliance shall not be cleaned with a steam cleaner.
- The appliance is intended to be used freestanding.
- The rear surface of appliances shall be placed against a wall.
- The appliances are not intended to be operated by means of an external timer or separate remote-control system.
- The temperature of accessible surfaces may be high when the appliance is operating.

## **▲ WARNING**

When the appliance is operated in the combination mode, children should only use the oven under adult supervision due to the temperatures generated.

**READ CAREFULLY AND KEEP  
FOR FUTURE REFERENCE**

## To Reduce The Risk Of Injury To Persons Grounding Installation

### **⚠ DANGER**

Electric Shock Hazard:

Touching some of the internal components can cause serious personal injury or death. Do not disassemble this appliance.

### **⚠ WARNING**

Electric Shock Hazard:

Improper use of the grounding can result in electric shock. Do not plug into an outlet until appliance is properly installed and grounded.

This appliance must be grounded. In the event of an electrical short circuit, grounding reduces the risk of electric shock by providing an escape wire for the electric current.

This appliance is equipped with a cord having a grounding wire with a grounding plug. The plug must be plugged into an outlet that is properly installed and grounded.

Consult a qualified electrician or serviceman if the grounding instructions are not completely understood or if doubt exists as to whether the appliance is properly grounded.

If it is necessary to use an extension cord, use only a 3-wire extension cord.

1. A short power-supply cord is provided to reduce the risks resulting from becoming entangled in or tripping over a longer cord.

2. If a long cord set or extension cord is used:
  - 1) The marked electrical rating of the cord set or extension cord should be at least as great as the electrical rating of the appliance.
  - 2) The extension cord must be a grounding-type 3-wire cord.
  - 3) The long cord should be arranged so that it will not drape over the counter top or tabletop where it can be pulled on by children or tripped over unintentionally.

## Utensils

### CAUTION

Personal Injury Hazard:

It is hazardous for anyone other than a competent person to carry out any service or repair operation that involves the removal of a cover which gives protection against exposure to microwave energy.

See the instructions on "Materials you can use in microwave oven or to be avoided in microwave oven."

There may be certain non-metallic utensils that are not safe to use for microwaving. If in doubt, you can test the utensil in question following the procedure below.

### **Utensil Test:**

- Fill a microwave-safe container with 1 cup of cold water (250ml) along with the utensil in question.
- Cook on maximum power for 1 minute.
- Carefully feel the utensil. If the empty utensil is warm, do not use it for microwave cooking.
- Do not exceed 1 minute cooking time.

## Materials You Can Use In Microwave Oven

Utensils	Remarks
Browning dish	Follow manufacturer's instructions. The bottom of browning dish must be at least 3/16 inch (5mm) above the turntable. Incorrect usage may cause the turntable to break.
Dinnerware	Microwave-safe only. Follow manufacturer's instructions. Do not use cracked or chipped dishes.
Glass jars	Always remove lid. Use only to heat food until just warm. Most glass jars are not heat resistant and may break.
Glassware	Heat-resistant oven glassware only. Make sure there is no metallic trim. Do not use cracked or chipped dishes.
Oven cooking bags	Follow manufacturer's instructions. Do not close with metal tie. Make slits to allow steam to escape.
Paper plates and cups	Use for short-term cooking/warming only. Do not leave oven unattended while cooking.
Paper towels	Use to cover food for reheating and absorbing fat. Use with supervision for a short-term cooking only.
Parchment paper	Use as a cover to prevent splattering or a wrap for steaming.
Plastic	Microwave-safe only. Follow the manufacturer's instructions. Should be labeled "Microwave Safe". Some plastic containers soften, as the food inside gets hot. "Boiling bags" and tightly closed plastic bags should be slit, pierced or vented as directed by package.
Plastic wrap	Microwave-safe only. Use to cover food during cooking to retain moisture. Do not allow plastic wrap to touch food.
Thermometers	Microwave-safe only (meat and candy thermometers).
Wax paper	Use as a cover to prevent splattering and retain moisture.

## Materials To Be Avoided In Microwave Oven

Utensils	Remarks
Aluminum tray	May cause arcing. Transfer food into microwave-safe dish.
Food carton with metal handle	May cause arcing. Transfer food into microwave-safe dish.
Metal or metal-trimmed utensils	Metal shields the food from microwave energy. Metal trim may cause arcing.
Metal twist ties	May cause arcing and could cause a fire in the oven.
Paper bags	May cause a fire in the oven.
Plastic foam	Plastic foam may melt or contaminate the liquid inside when exposed to high temperature.
Wood	Wood will dry out when used in the microwave oven and may split or crack.

# SPECIFICATION

<b>Model</b>	<b>MMO25PFA-ACSF BK</b>
Rated Voltage	230-240 V- 50 Hz
Rated Input (Microwave)	1380 W
Rated Output (Microwave)	900 W
Rated Input (Grill)	2100-2300 W
Rated Input (Convection)	2100-2300 W

---



# PRODUCT OVERVIEW

## Names of Oven Parts and Accessories

In case of any differences between the appliance and the pictures in this manual, the product shall prevail.

Remove the oven and all materials from the carton and oven cavity.  
Your oven comes with the following accessories:

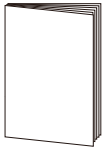

Instruction Manual

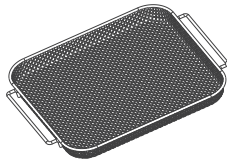

Airfry basket (Cannot be used in microwave and combination, it should be used for airfry)

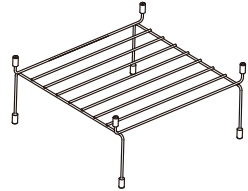

Grill Rack (Cannot be used in microwave function and must be placed on the glass tray)

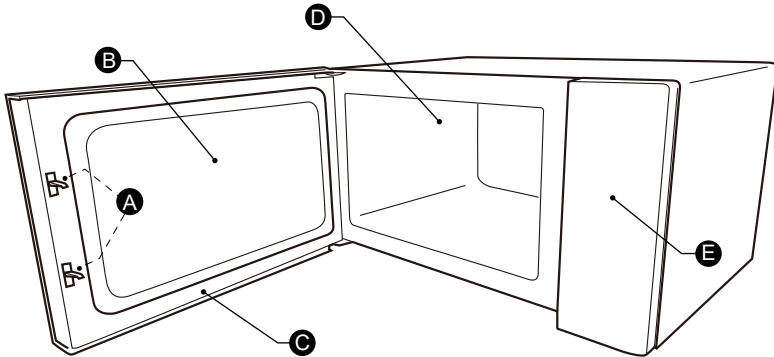

- A) Safety interlock system
- B) Observation window
- C) Door assembly

- D) Oven cavity
- E) Control panel

# PRODUCT INSTALLATION

## Countertop Installation

Remove all packing material and accessories. Examine the oven for any damage such as dents or broken door. Do not install if oven is damaged.

Cabinet: Remove any protective film found on the microwave oven cabinet surface. Do not remove the Waveguide cover that is attached to the oven cavity to protect the magnetron.

## Installation

1. Select a level surface that provide enough open space for the intake and/or outlet vents.
  - The minimum installation height is 85cm.
  - The rear surface of appliance shall be placed against a wall. Leave a minimum clearance of 30cm above the oven. A minimum clearance of 20cm is required between the oven and any adjacent walls.
  - Do not remove the legs from the bottom of the oven.
  - Blocking the intake and/or outlet openings can damage the oven.
  - Place the oven as far away from radios and TV as possible. Operation of microwave oven may cause interference to your radio or TV reception.

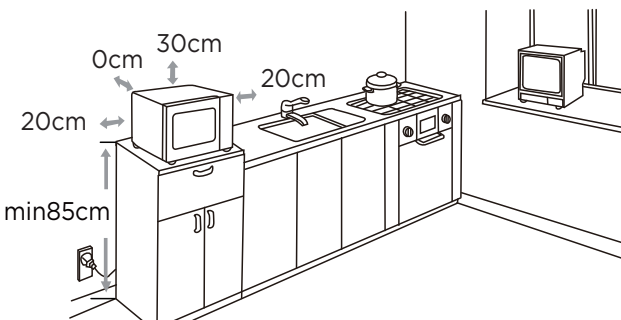

2. Plug your oven into a standard household outlet. Be sure the voltage and the frequency is the same as the voltage and the frequency on the rating label.

**⚠ WARNING**

Do not install oven over a range cooktop or other heat-producing appliance. If installed near or over a heat source, the oven could be damaged and the warranty would be void.



**The accessible surface may be hot during operation.**

# OPERATION INSTRUCTIONS

## Control Panel

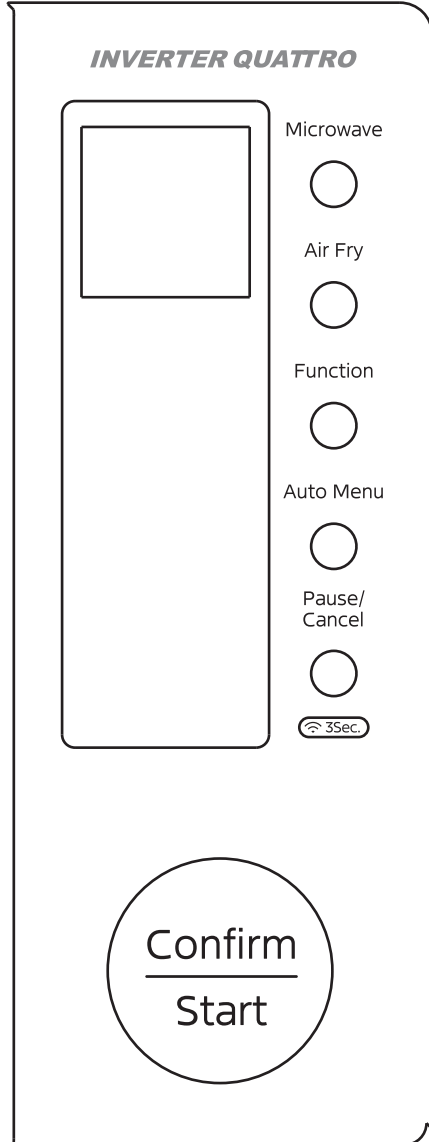

## Standby Mode

- (1) When the microwave oven is plugged into an outlet, “0” shows on the display. The Buzzer sounds.
- (2) In the setting or pause state, press “  $\frac{\text{Pause/}}{\text{Cancel}}$  ” once to enter the standby mode.
- (3) Once the cooking settings are configured, if “  $\frac{\text{Confirm}}{\text{Start}}$  ” is not pressed within 5 minutes, the oven will return to standby mode. The setting is invalid.

## Microwave Heating

- (1) Press “ Microwave ” once and then “100” and “1m00s” will display.
- (2) Turn the knob to adjust the cooking time. The maximum time value is “1h35m”.
- (3) Press “  $\frac{\text{Confirm}}{\text{Start}}$  ” to start heating.



### NOTE

- (1) During the heating process, turning the knob allows for direct time adjustment and immediate operation.
- (2) The beeping only occurs on the first rotation of the knob.

## Air Fry

- (1) Press “ Air Fry ” once to enter the air fry function, the default temperature “ 180°C ” will display.
- (2) Turn the knob to set the temperature. The maximum temperature value is “ 240°C ”.
- (3) Press “  $\frac{\text{Confirm}}{\text{Start}}$  ” to confirm the temperature.
- (4) Turn the knob to set the temperature. The maximum time value is “1h35m”.
- (5) Press “  $\frac{\text{Confirm}}{\text{Start}}$  ” to start cooking.

## Preheat Function

- (1) Press “ Function ” once to enter the Preheat function, the default temperature “ 150°C ” will display.
- (2) Turn the knob to set the temperature. The maximum temperature value is “ 230°C ”.
- (3) Press “  $\frac{\text{Confirm}}{\text{Start}}$  ” to start preheating.
- (4) When preheating is completed, the oven will sound.
- (5) Open the door and place food in the oven, and then close the oven door, and based on the set preheating temperature, switch to the corresponding function mode.

### NOTE

After preheating is complete without opening the oven door, it will keep warm for 1 hour. Every 10 minutes, the oven will sound and then return to standby mode.

## Grill Cooking

- (1) Press “ Function ” twice to enter the grill cooking function, the default temperature “ 150°C ” will display.
- (2) Turn the knob to set the temperature. The maximum temperature value is “ 230°C ”.
- (3) Press “  $\frac{\text{Confirm}}{\text{Start}}$  ” to confirm the temperature.
- (4) Turn the knob to set the time. The maximum time value is “1h35m”.
- (5) Press “  $\frac{\text{Confirm}}{\text{Start}}$  ” to start cooking.

### NOTE

The buzzer will sound to remind you to turn the food over during grill cooking. If no operation, the oven will continue working.

## Combination Cooking

- (1) Press “ Function ” thrice to enter the combination cooking function, the default time “ 30:00 ” will display.
- (2) Turn the knob to select the time. The maximum time value is “1h35m”.
- (3) Press “  $\frac{\text{Confirm}}{\text{Start}}$  ” to start cooking.

## Microwave Cooking

5 power levels are available.

Power	100%	80%	50%	30%	10%
Display	100%	80%	50%	30%	10%

- (1) Press “ Function ” four times to enter the microwave cooking function, the default power “ 100% ” will display.
- (2) Turn the knob to set the power level and then press “  $\frac{\text{Confirm}}{\text{Start}}$  ” to confirm.
- (3) Turn the knob to adjust the cooking time. The maximum time value is “1h35m”.
- (4) Press “  $\frac{\text{Confirm}}{\text{Start}}$  ” to start cooking.

## Re-Crisp Function

- (1) Press “ Function ” five times to enter the re-crisp function, the default temperature “ 230°C ” will display.
- (2) Turn the knob to select the time. The maximum time value is “1h35m”.
- (3) Press “  $\frac{\text{Confirm}}{\text{Start}}$  ” to start cooking.



### NOTE

The buzzer will sound to remind you to turn the food over during cooking. If no operation, the oven will continue working.

## Auto Menu







- (1) In standby mode, press “ Auto Menu ” once and then the screen will display “01”.
- (2) Turn the knob to choose the menu you need. 30 auto menus are available.
- (3) Press “ Confirm  
Start ” to confirm.
- (4) Press “ Confirm  
Start ” to start cooking.

### Auto Menu chart

Menu	Weight/ Time	Display	Power	Reminder
01 New Orleans Style Chicken Wings	500g	500g	AirFry 230°C	the buzzer will sound during cooking to remind you to turn the food over
02 Roasted Sweet Potato	1000g	1.0kg	Grill 230°C	
03 Salt and Pepper Prawns	400g	400g	AirFry 240°C	----
04 Grilled Chicken Sausage	400g	400g	Grill 220°C	the buzzer will sound during cooking to remind you to turn the food over
05 Chicken Breast with Black Pepper	250g	250g	Grill 230°C	
06 French Fries	250g	250g	AirFry 230°C	
07 Fried Chicken Filletts	280g	280g	AirFry 230°C	
08 Coconut Bread Loaf	100g	100g	Grill 150°C	



Menu	Weight/ Time	Display	Power	Reminder
09 Fried Chicken Drumsticks	350g	350g	AirFry 230°C	the buzzer will sound during cooking to remind you to turn the food over
10 Honey Chestnut	500g	500g		
11 Deep-fried Peanuts	200g	200g		
12 Fried Calamari	220g	220g		
13 Fried Cheese Strips	320g	320g		
14 Lava Toast	100g	100g	Grill 180°C	
15 Chiffon Cake	8 inches (500g)	500g	AirFry 170 °C	----
16 Chocolate Cup Cake	6(270g)	270g	AirFry 190°C	
17 Cranberry Cookies	400g	400g	AirFry 155°C	
18 Whole Wheat Bread	1(600g)	600g	AirFry 190°C	
19 Garlic Bread	160g	160g	Grill 230°C	the buzzer will sound during cooking to remind you to turn the food over
20 Roast Chicken 	1300g	1.3kg	Microwave 80%+ AirFry 230°C	
21 Cumin Lamb Chops 	500g	500g	Microwave 100%+ AirFry 230°C	

Menu	Weight/Time	Display	Power	Reminder
22 Roast Beef 	300g	300g	Microwave 100%+ AirFry 230°C	the buzzer will sound during cooking to remind you to turn the food over
23 Baked Frozen Pizza 	340g	340g	Microwave+Grill	
24 Steamed Fish with Soy Sauce 	200g	200g	80%	---
	300g	300g		
	400g	400g		
	500g	500g		
	600g	600g		
25 Mapo Tofu 	200g	200g	80%	---
	300g	300g		
	400g	400g		
	500g	500g		
26 Fast Defrost 	100-2000g	100g-2.0kg	----	the buzzer will sound during defrosting to remind you to turn the food over
	100g	100g	10%	----
27 Butter Softening 	100g	100g	10%	----
28 Fermentation	5s-12hours	5s-12h00m	----	When the oven temperature is above 60°C and then the screen will display "F01".
29 Cavity Deodorization	5s-95min	5s-1h35min	----	To remove the odor of the oven, the oven will work with fan.
30 Microwave Sterilization 	3min	3m00s	----	Before sterilizing, please moisten the utensils.

 **NOTE**

When using auto menus with microwave output, in-house grill rack can be used. Please do NOT put the air fry basket or any other metal accessories into the cavity.

 refers to auto menu with microwave, please do NOT use metal accessories.

## More Functions

### 10-1 Steamed Fish with Soy Sauce/Mapo Tofu

- (1) In standby mode, press “ Auto Menu ” once and then the screen will display “01”.
- (2) Turn the knob to choose the menu 24/25. “24”/ “25” will display.
- (3) Press “  $\frac{\text{Confirm}}{\text{Start}}$  ” to confirm.
- (4) Turn the knob to set the weight.
- (4) Press “  $\frac{\text{Confirm}}{\text{Start}}$  ” to start cooking.

### 10-2 Fast Defrost

- (1) In standby mode, press “ Auto Menu ” once and then the screen will display “01”.
- (2) Turn the knob to choose the menu 26, “26” will display.
- (3) Press “  $\frac{\text{Confirm}}{\text{Start}}$  ” to confirm the menu.
- (4) Turn the knob to set the weight. The range of weight is 100g to 2.0kg.
- (5) Press “  $\frac{\text{Confirm}}{\text{Start}}$  ” to start defrosting.



#### NOTE

The buzzer will sound during defrosting to remind you to turn the food over. If no operation, the oven will continue working.

### 10-3 Butter Softening

- (1) In standby mode, press “ Auto Menu ” once and then the screen will display “01”.
- (2) Turn the knob to choose the menu 27, “27” will display.
- (3) Press “  $\frac{\text{Confirm}}{\text{Start}}$  ” to confirm the menu.
- (4) Turn the knob to enter the weight, the default weight “ 100g ”will display.
- (5) Press “  $\frac{\text{Confirm}}{\text{Start}}$  ” to start softening.

#### 10-4 Fermentation

- (1) In standby mode, press “ Auto Menu ” once and then the screen will display “01”.
- (2) Turn the knob to choose the menu 28, “28” will display.
- (3) Press “  $\frac{\text{Confirm}}{\text{Start}}$  ” to confirm the menu.
- (4) Turn the knob to set the temperature. The range of temperature is 25°C-45°C.
- (5) Press “  $\frac{\text{Confirm}}{\text{Start}}$  ” to confirm the temperature.
- (6) Turn the knob to set the time, the maximum value is “12h00m”.
- (7) Press “  $\frac{\text{Confirm}}{\text{Start}}$  ” to start cooking.

#### NOTE

When the oven temperature is above 60°C and then the screen will display “F01”.

#### 10-5 Cavity Deodorization

- (1) In standby mode, press “ Auto Menu ” once and then the screen will display “01”.
- (2) Turn the knob to choose the menu 29.
- (3) Press “  $\frac{\text{Confirm}}{\text{Start}}$  ” to confirm.
- (4) Turn the knob to set the time, the maximum value is “1h35m”.
- (5) Press “  $\frac{\text{Confirm}}{\text{Start}}$  ” to start .

#### NOTE

To remove the odor of the oven, the oven will work with fan.

#### 10-6 Microwave Sterilization

- (1) In standby mode, press “ Auto Menu ” once and then the screen will display “01”.
- (2) Turn the knob to choose the menu 30.
- (3) Press “  $\frac{\text{Confirm}}{\text{Start}}$  ” to confirm the mode.
- (4) Press “  $\frac{\text{Confirm}}{\text{Start}}$  ” to start for 3m00s.

#### NOTE

Before sterilizing, please moisten the utensils.

## Wireless Connection

### Connect the network

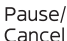
In standby state, press and hold “  ” for 3 seconds, till a beep sounds, “AP” will display. If it fails, “NO” will display, and the oven will return to standby after 30 seconds.

### Disconnect from the network

Press and hold “  ” for 8 seconds, till a beep sounds, “--” displays for few seconds, if the link has been removed successfully, the screen will display “8888” and then return to standby after 3 seconds. If it fails, “FFFF” will display, and the oven will return to standby after 3 seconds.

# APP SETUP AND OPERATION

## Quick Start Guide

CONNECT YOUR DEVICE TO YOUR MOBILE PHONE WITH SmartHome App

1

### Download the SmartHome App

Scan QR code or find us on your App store

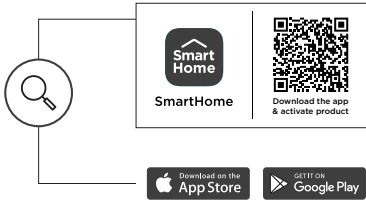

2

### Register and log in

Log in for existing users or sign up for new users

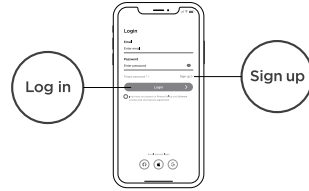

3

### Connect your devices to SmartHome

**STEP1.** Connect to wireless network and enable Bluetooth

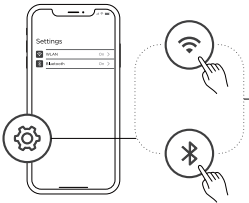

**STEP2.** Open the SmartHome App. Power on selected device

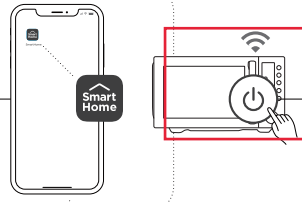

**STEP3.** Add your device using one of the following methods:

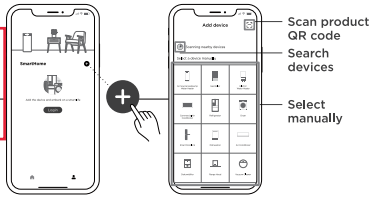

**STEP4.** Ensure device and App are under same wireless network.



**STEP5.** Press "Wi-Fi" button for 3 seconds on the panel. Following instruction to set up, it will connect automatically.

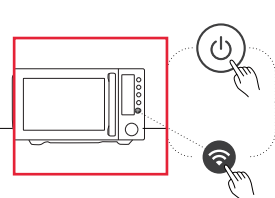

**STEP6.** Rename your device and try to remote control it.

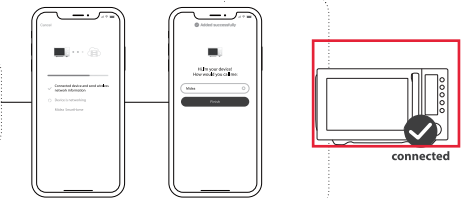

## Quick Tips

- Make sure your devices are powered on.
- Keep your mobile phone close to your device during connection.
- Connect your mobile phone to the wireless network at home.
- Enable the 2.4GHz frequency on your wireless network router. Contact the manufacturer if unsure whether the router supports 2.4GHz.
- The device is unable to connect to wireless network that requires authentication and also appears in public areas such as hotels and restaurants.
- It is recommended to use a wireless network name that only contains letters and numbers. If your wireless network name contains special characters, modify it in the router. Disable WLAN+ (Android) or WLAN Assistant (iOS) when connecting your devices to the network.
- To reconnect a device to the wireless network, click "+" on the App home screen and add the device again by the category and model according to the App prompts.

# CLEANING AND MAINTENANCE

Be sure to unplug the appliance from the power supply.

- Clean the cavity of the oven after using with a slightly damp cloth.
- Clean the accessories in the usual way in soapy water.
- The door frame and seal and neighbouring parts must be cleaned carefully with a damp cloth when they are dirty.
- Do not use harsh abrasive cleaners or sharp metal scrapers to clean the oven door glass since they can scratch the surface, which may result in shattering of the glass.
- Cleaning Tip---For easier cleaning of the cavity walls that the food cooked can touch: Place half a lemon in a bowl, add 300ml (1/2 pint) water and heat on 100%microwave power for 10 minutes. Wipe the oven clean using a soft, dry cloth.

# TROUBLE SHOOTING

Normal	
Microwave oven interfering TV reception	Radio and TV reception may be interfered when microwave oven operating. It is similar to the interference of small electrical appliances, like mixer, vacuum cleaner, and electric fan. It is normal.
Dim oven light	In low power microwave cooking, oven light may become dim. It is normal.
Steam accumulating on door, hot air out of vents	In cooking, steam may come out of food. Most will get out from vents. But some may accumulate on cool place like oven door. It is normal.
Oven started accidentally with no food in.	It is forbidden to run the unit without any food inside. It is very dangerous.

Trouble	Possible Cause	Remedy
Oven cannot be started.	(1) Power cord is not plugged in tightly.	Unplug. Then plug again after 10 seconds.
	(2) Fuse blowing or circuit breaker works.	Replace fuse or reset circuit breaker (repaired by professional personnel of our company)
	(3) Trouble with outlet.	Test outlet with other electrical appliances.
Oven does not heat.	(4) Door is not closed well.	Close door well.



According to Waste of Electrical and Electronic Equipment (WEEE) directive, WEEE should be separately collected and treated. If at any time in future you need to dispose of this product please do NOT dispose of this product with household waste. Please send this product to WEEE collecting points where available.



# TRADEMARKS, COPYRIGHTS AND LEGAL STATEMENT

 Midea logo, word marks, trade name, trade dress and all versions thereof are valuable assets of Midea Group and/or its affiliates (“Midea”), to which Midea owns trademarks, copyrights and other intellectual property rights, and all goodwill derived from using any part of an Midea trademark. Use of Midea trademark for commercial purposes without the prior written consent of Midea may constitute trademark infringement or unfair competition in violation of relevant laws.

This manual is created by Midea and Midea reserves all copyrights thereof. No entity or individual may use, duplicate, modify, distribute in whole or in part this manual, or bundle or sell with other products without the prior written consent of Midea.

All the described functions and instructions were up to date at the time of printing this manual. However, the actual product may vary due to improved functions and designs.

# DATA PROTECTION NOTICE

For the provision of the services agreed with the customer, we agree to comply without restriction with all stipulations of applicable data protection law, in line with agreed countries within which services to the customer will be delivered.

Generally, our data processing is to fulfil our obligation under contract with you and for product safety reasons, to safeguard your rights in connection with warranty and product registration questions. In some cases, but only if appropriate data protection is ensured, personal data might be transferred to recipients located outside of the European Economic Area.

Further information are provided on request. You can contact our Data Protection Officer via **MideaDPO@midea.com**. To exercise your rights such as right to object your personal data being processed for direct marketing purposes, please contact us via **MideaDPO@midea.com**. To find further information, please follow the QR Code.





*make yourself at home*



[www.midea.com](http://www.midea.com)

© Midea 2024 all rights reserved

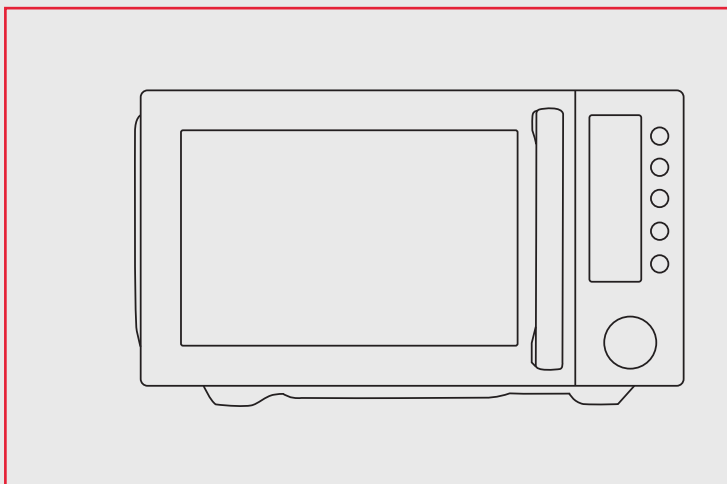

微波炉

SmartHome

下载应用程序  
& 激活产品

# 用户手册

MMO25PFA-ACSF BK

警告提示：在使用本产品前，请仔细阅读并保存好本说明书以备日后参考。设计及规格如有更改，恕不另行通知。详询经销商或制造商。

上图仅供参考。请以实物外观为准。

## 感谢信

感谢您选择美的！使用新的美的产品之前，请仔细阅读本手册，以确保您知道如何安全地操作新设备的各项功能。

# 目录

感谢信	CN-01
安全说明	CN-02
规范	CN-10
产品概述	CN-11
产品安装	CN-12
使用方法	CN-14
应用程序设置与操作	CN-24
清洁和维护	CN-25
故障排除	CN-26
商标、版权和法律声明	CN-27
数据保护公告	CN-28

# 安全说明

## 预期用途

以下安全指南旨在防止不安全或不正确操作电器造成的不可预见的风险或损坏。到货时请检查包装和电器，确保一切完好无损，以确保安全操作。如果发现任何损坏，请联系零售商或经销商。请注意，出于安全考虑，请勿擅自对电器进行修理或改装。非预期用途使用本产品可能会造成危害和失去保修资格。

## 符号说明

	<b>危险</b> 表示极易燃气体体会危及生命和健康安全。
	<b>电压警告</b> 表示电压会危及生命和健康安全。
	<b>警告</b> 表示中等风险，如果未能避免，可能导致死亡或重伤。
	<b>注意</b> 表示较低风险，如果未能避免，可能导致轻度或中度伤害。
	<b>请注意</b> 表示重要信息（如财产损失），但不表示危险。
	<b>遵守指示</b> 表示维修技术人员只能按照操作说明操作维护本产品。

使用 / 调试产品前，请仔细阅读有关使用说明，并将其储存在安装地点或产品附近，以备日后使用！

## 避免可能暴露于过量微波能的预防措施

- a. 禁止在门打开的情况下操作该微波炉，因为这会导致您暴露于有害的微波能之下。  
不得破坏或篡改安全联锁装置。
- b. 请勿在微波炉正面和炉门之间放置任何物体，或让灰尘或清洁剂残留物积聚在密封面上。
- c. 如果微波炉损坏，请勿操作。尤其重要的是，微波炉门必须正确关闭，并且没有以下损坏：
  - 门（弯曲）
  - 铰链和门锁（损坏或松动）
  - 门密封条和密封面
- d. 除合格的维修人员外，任何人不得调整或修理本微波炉。

## 补充说明

如果本电器未能保持良好的清洁状态，其表面可能会退化，使用寿命也会缩短，导致危险情况。



## 重要安全须知

为降低使用本电器时发生火灾、触电、人身伤害或过量微波炉能暴露的风险，请遵循以下基本预防措施：

### ▲ 警告

- 阅读并遵循具体内容：“避免可能暴露于过量微波能的预防措施”。
- 本电器不适合体力、感官或智力不佳或缺乏经验和知识的人员（包括儿童）使用，除非有负责其安全的人员对其使用进行监督或指导。
- 请看管好儿童，切勿让儿童玩耍本电器。
- 如果电源线损坏，必须由制造商、其服务代理或类似合格人员进行更换，以免发生危险。
- 警告：为避免触电，更换灯泡前，请确保产品电源已关闭。
- 警告：必须由合格人员执行与拆卸微波能量盖（此盖可防止人员暴露于微波能量之中）相关的任何服务或维修操作，否则会造成危险。
- 警告：不得在密封容器中加热液体和其他食物放在，否则容易引发爆炸。
- 使用塑料或纸质容器加热食物时，请注意观察微波炉，以防着火。
- 应仅使用适用于微波炉的器皿。
- 如果冒烟，请关闭本电器或拔下插头，并保持门关闭，以达到灭火目的。
- 用微波炉加热饮料会导致延迟喷发沸腾，因此在拿取容器时必须小心。

- 为避免烫伤，在饮用前，应搅拌或摇动奶瓶和婴儿食物罐的内容物，并检查温度。
- 不得将带壳的鸡蛋和全熟鸡蛋放在微波炉中加热，因为即使在微波加热结束后，它们也可能爆炸。
- 应定期清洁微波炉，并清除食物沉积物。
- 未能保持微波炉清洁可能导致表面退化，从而可能影响本电器的寿命，并造成危险。
- 不得将电器安装在装饰门后面，以避免过热。（不适用于带装饰门的电器。）
- 仅使用针对本微波炉推荐的温度探头。（适用于配有温度传感探头设施的微波炉。）
- 除非已在机柜中开展测试，否则不得将微波炉放置在机柜中。
- 必须在装饰门打开的情况下操作微波炉。（对于带装饰门的微波炉。）
- 本电器拟用于家用和下列类似用途：
  - 车间、办公室和其他工作环境中的员工厨房区域；
  - 酒店、汽车旅馆和其他居住场所中的客户；
  - 农舍；
  - 住宿和早餐供应场所。
- 微波炉用于加热食物和饮料。烘干食物或者衣服以及加热电热垫、拖鞋、海绵、湿布等可能会造成受伤、着火或者火灾的风险。
- 微波烹饪时，不得使用金属容器盛装食物和饮料。
- 不得使用蒸汽清洁器清洁本电器。
- 本电器为独立式设备。

- 本电器的背面应靠墙放置。
- 请勿通过外部计时器或单独的遥控系统操作本电器。
- 设备运行期间表面温度可能较高。

### **▲ 警告**

当本电器以组合模式运行时，由于会产生高温，故儿童只能在成人监督下使用微波炉。

## **仔细阅读并妥善保存 以备参考**

### **降低对人员接地装置造成伤害的风险**

### **▲ 危险**

触电危险：

触摸某些内部部件会导致严重的人身伤害或死亡。请勿拆卸本电器。

### **▲ 警告**

触电危险：

接地不当会导致触电。在电器正确安装和接地前，请勿插入插座。

本电器必须接地。若发生电气短路，接地可以为电流提供逃逸线，从而减少触电风险。

本电器配有一根电线，该电线带有接地线和接地插头。插头必须插入正确安装和接地的插座。

如果不完全理解接地说明，或者如果对本电器是否正确接地存在疑问，请咨询合格的电工或维修人员。

如果需要使用延长线，仅使用 3 芯延长线。

1. 提供短电源线，以减少被长电源线缠住或绊倒的风险。
2. 如果使用长线组或延长线：
  - 1) 线组或延长线的标记电气额定值应至少与本电器的电气额定值相等。
  - 2) 延长线必须是接地型三芯线。
  - 3) 长线的布置应确保其不会悬垂在台面或桌面上，以免被儿童拉扯或无意中绊倒他人。

## 器具

### ⚠ 注意

人身伤害危险：

必须由合格人员执行与拆卸微波能量盖（此盖可防止人员暴露于微波能量之中）相关的任何服务或维修操作，否则会造成危险。

参见“可用于微波炉的材料”或“不可用于微波炉的材料”。某些非金属器具可能不适合用于微波炉。如有疑问，您可以按照以下程序测试有问题的器具。

### 器具测试：

- 向一个微波安全容器中加入1杯冷水（250 ml），将该容器和待测试器具一起放入微波炉。
- 在最大功率下烹饪1分钟。
- 仔细触摸器具。如果器具空置时仍有热度，请勿用于微波烹饪。
- 烹饪时间不得超过1分钟。

## 可用于微波炉的材料

器具	备注
烧烤盘	遵循制造商的说明。烧烤盘的底部必须在转盘上方至少 3/16 英寸（5mm）。使用不当可能造成转盘损坏。
餐具	仅微波专用。遵循制造商的说明。请勿使用有裂纹或者缺口的盘子。
玻璃罐	务必取下盖子。仅用于加热食物，直至食物刚好变热。大多数玻璃罐不耐热，可能会破裂。
玻璃器皿	仅限耐热微波炉玻璃器皿。确保没有金属装饰。请勿使用有裂纹或者缺口的盘子。
微波炉烹饪袋	遵循制造商的说明。请勿使用金属扎带封闭袋口。留缝让蒸汽逸出。
纸盘和纸杯	仅用于短时间烹饪 / 加热。烹饪时，微波炉必须始终有人看管。
纸巾	用于覆盖食物以重新加热和吸收脂肪。仅在监督下用于短时间烹饪。
烤盘纸	用作盖子防止飞溅，或用作包装防止蒸汽溢出。
塑料	仅微波专用。遵循制造商的说明。应该贴上“微波安全”的标签。当里面的食物变热时，一些塑料容器会软化。应按照包装上的说明，对“可煮袋”和密封塑料袋进行开口、穿孔或通风处理。
保鲜膜	仅微波专用。用于烹饪时覆盖食物，以保持水分。请勿让保鲜膜接触食物。
温度计	仅微波专用（肉类和糖果温度计）。
蜡纸	用作盖子防止飞溅并保持水分。

## 不可用于微波炉的材料

器具	备注
铝托盘	可能导致电弧放电。应将食物转移到微波炉安全盘中。
带金属手柄的食物纸箱	可能导致电弧放电。应将食物转移到微波炉安全盘中。
金属或金属装饰容器	金属遮罩微波能量。金属装饰可能导致电弧放电。
金属扎带	可能导致电弧放电，并导致微波炉起火。
纸袋	纸袋可能会导致微波炉起火。
塑料泡沫	暴露在高温下时，塑料泡沫可能会熔化或污染内部液体。
木制品	木制器皿在微波炉中使用时会变干，并可能开裂。

# 规格

<b>型号</b>	<b>MMO25PFA-ACSF BK</b>
额定电压	230-240V~ 50 Hz
额定输入（微波）	1380 W
额定输出（微波）	900 W
额定输入（烧烤）	2100-2300 W
额定输入（热风）	2100-2300 W

---

# 产品概述

## 微波炉零件和配件名称

若产品实物与说明书图片有差异，请以实物为准。

从纸箱和微波炉腔体中取出微波炉和所有材料。

微波炉配件包括：



说明书

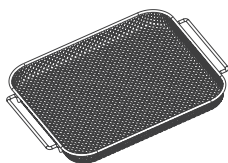

空气炸篮（不能用于微波和组合功能，应该用于空气炸）

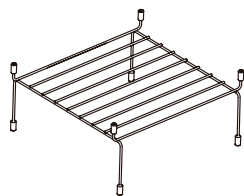

烤架（不能用于微波功能，必须放置在玻璃托盘上）

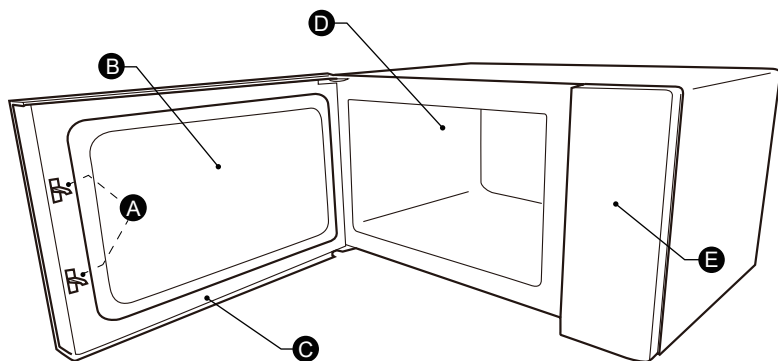

A) 安全联锁系统

B) 观察窗

C) 门组件

D) 炉腔

E) 控制面板



# 产品安装

## 台面安装

拆除所有包装材料和附件。检查微波炉是否有任何损坏，如凹痕或者门破损。如发现微波炉有任何损坏，请勿安装。

机柜：去除微波炉机柜表面的保护膜。请勿取下粘在微波炉腔体上保护磁控管的波导盖。

## 安装

1. 选择一个水平面，为进气口和 / 或排气口留出足够的开放空间。
  - 最小安装高度为 85cm。
  - 本电器的背面应靠墙放置。在微波炉上方至少留出 30cm 的间隙。微波炉和任何相邻墙壁之间需要至少 20cm 的间隙。
  - 请勿取下微波炉底部的支脚。
  - 堵塞进出气口会损坏微波炉。
  - 将微波炉放置在尽可能远离收音机和电视的地方。操作微波炉可能会干扰收音机或电视接收信号。

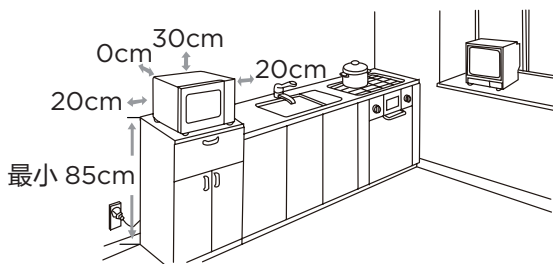

2. 将微波炉插头插入标准家用插座。

请确保微波炉的电压和频率与标签上的额定电压和频率相同。

**▲ 警告**

请勿将微波炉安装在炉灶面或其他发热电器上方。如果安装在热源附近或上方，微波炉可能会损坏，保修将失效。



微波炉运行期间，可接触表面会变热。

# 使用方法

## 控制面板

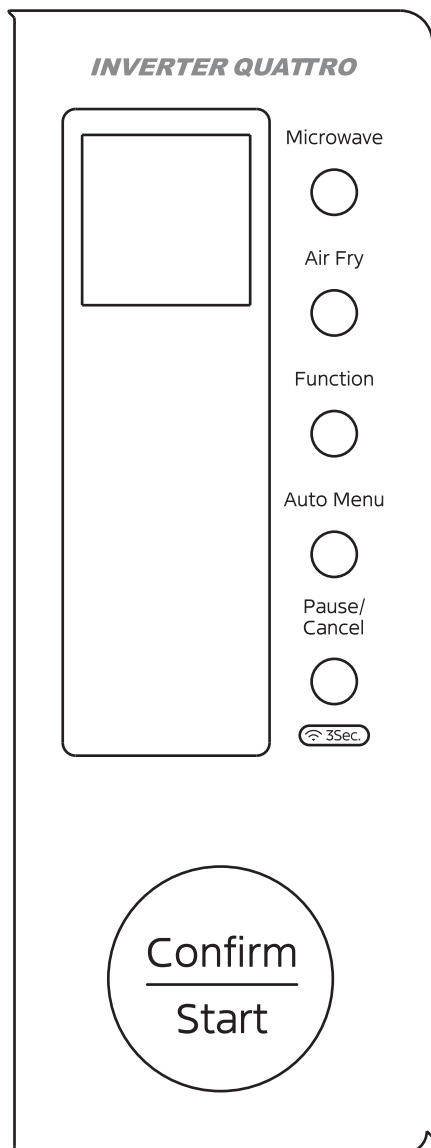

Microwave	微波
Air Fry	空气炸
Function	功能
Auto Menu	自动菜单
Pause/ Cancel	暂停 / 取消
<u>Confirm</u> Start	<u>确定</u> 开始

## 待机模式

- (1) 微波炉接入电源插座后，显示屏显示“0”。蜂鸣器响。
- (2) 在设置或暂停状态下，按“ $\frac{\text{Pause/}}{\text{Cancel}}$ ”键进入待机模式。
- (3) 烹饪设置一经配置，如果在5分钟内未按“ $\frac{\text{Confirm}}{\text{Start}}$ ”键，微波炉将返回待机模式，设置无效。

## 微波加热

- (1) 按下“Microwave”键，屏幕显示“100”和“1m00s”。
- (2) 旋转旋钮调节烹饪时间。最长时间为“1h35m”。
- (3) 按“ $\frac{\text{Confirm}}{\text{Start}}$ ”键开始加热。

### ● 注

- (1) 加热过程中，转动旋钮可直接进行时间调整和即时操作。
- (2) 仅在第一次旋转旋钮时发出蜂鸣声。

## 空气炸

- (1) 按“Air Fry”键进入空气炸炸功能，显示默认温度“180°C”。
- (2) 旋转旋钮设置温度。最高温度为“240°C”。
- (3) 按“ $\frac{\text{Confirm}}{\text{Start}}$ ”键确认温度。
- (4) 旋转旋钮设置温度。最长时间为“1h35m”。
- (5) 按“ $\frac{\text{Confirm}}{\text{Start}}$ ”键开始烹饪。

## 预热功能

- (1) 按一下“Function”键进入预热功能，显示默认温度“150°C”。
- (2) 旋转旋钮设置温度。最高温度为“230°C”。
- (3) 按“ $\frac{\text{Confirm}}{\text{Start}}$ ”键开始预热。
- (4) 预热完成后，微波炉会发出声音提示。
- (5) 打开炉门，将食物放入炉内，关上炉门，根据设置的制热温度，切换到相应功能模式。

### 注

预热完成后，不打开炉门，会自动保温1小时。

每10分钟，微波炉会响一次，然后返回待机模式。

## 烧烤烹饪

- (1) 按两次“Function”键进入烧烤烹饪功能，显示默认温度“150°C”。
- (2) 旋转旋钮设置温度。最高温度为“230°C”。
- (3) 按“ $\frac{\text{Confirm}}{\text{Start}}$ ”键确认温度。
- (4) 旋转旋钮设置时间。最长时间为“1h35m”。
- (5) 按“ $\frac{\text{Confirm}}{\text{Start}}$ ”键开始烹饪。

### 注

烧烤烹饪过程中，蜂鸣器会响起，提醒您将食物翻面。

如果没有操作，微波炉将继续工作。

## 组合烹饪

- (1) 按三次“Function”键进入组合烹饪功能，显示默认时间“30:00”。
- (2) 旋转旋钮选择时间。最长时间为“1h35m”。
- (3) 按“ $\frac{\text{Confirm}}{\text{Start}}$ ”键开始烹饪。

## 微波烹饪

有 5 个功率等级。

功率	100%	80%	50%	30%	10%
显示	100%	80%	50%	30%	10%

- (1) 按四次“Function”键进入微波烹饪功能，显示默认功率“100%”。
- (2) 旋转旋钮设置功率等级，然后按“ $\frac{\text{Confirm}}{\text{Start}}$ ”键确认。
- (3) 旋转旋钮调整烹饪时间。最长时间为“1h35m”。
- (4) 按“ $\frac{\text{Confirm}}{\text{Start}}$ ”键开始烹饪。

## 复脆功能

- (1) 按五次“Function”键进入复脆功能，显示默认温度“230°C”。
- (2) 旋转旋钮选择时间。最长时间为“1h35m”。
- (3) 按“ $\frac{\text{Confirm}}{\text{Start}}$ ”键开始烹饪。

### 注

烹饪过程中，蜂鸣器会响起，提醒您将食物翻面。如果没有操作，微波炉将继续工作。

## 自动菜单







- (1) 待机状态下，按一下“Auto Menu”键，屏幕显示“01”。
- (2) 旋转旋钮选择您需要的菜单。有 30 个自动菜单可用。
- (3) 按“ $\frac{\text{Confirm}}{\text{Start}}$ ”键确认。
- (4) 按“ $\frac{\text{Confirm}}{\text{Start}}$ ”键开始烹饪。

### 自动菜单表

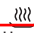
菜单	重量 / 时间	显示	烹饪方式	提醒
01 新奥尔良风味鸡翅	500g	500g	空气炸 230°C	烹饪过程中，蜂鸣器会响起， 提醒您将食物翻面。
02 烤红薯	1000g	1.0kg	烧烤 230°C	
03 椒盐大虾	400g	400g	空气炸 240°C	----
04 烤鸡肉肠	400g	400g	烧烤 220°C	烹饪过程中，蜂鸣器会响起， 提醒您将食物翻面。
05 黑椒鸡胸肉	250g	250g	烧烤 230°C	
06 炸薯条	250g	250g	空气炸 230°C	
07 炸鸡柳	280g	280g	空气炸 230°C	烹饪过程中，蜂鸣器会响起， 提醒您将食物翻面。
08 椰蓉吐司	100g	100g	烧烤 150°C	

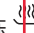
菜单	重量 / 时间	显示	烹饪方式	提醒	
09 炸鸡腿	350g	350g		烹饪过程中，蜂鸣器会响起，提醒您将食物翻面。	
10 蜂蜜栗子	500g	500g	空气炸 230°C		
11 炸花生	200g	200g			
12 炸鱿鱼	220g	220g			
13 炸芝士条	320g	320g			
14 熔岩吐司	100g	100g	烧烤 180°C		
15 戚风蛋糕	8 英寸 (500g)	500g	空气炸 170°C		
16 纸杯巧克力蛋糕	6(270g)	270g	空气炸 190°C		----
17 蔓越莓曲奇	400g	400g	空气炸 155°C		
18 全麦面包	1(600g)	600g	空气炸 190°C		
19 蒜蓉面包	160g	160g	烧烤 230°C		
20 烤鸡 🍗	1300g	1.3kg	微波 80%+ 空气 炸 230°C		烹饪过程中，蜂鸣器会响起，提醒您将食物翻面。
21 孜然羊排 🍖	500g	500g	微波 100%+ 空 气炸 230°C		



菜单	重量 / 时间	显示	烹饪方式	提醒
22  烤牛肉	300g	300g	微波 100%+ 空气 炸 230°C	烹饪过程中，蜂鸣器会响起，提醒您将食物翻面。
23  烤冷冻披萨	340g	340g	微波 + 烧烤	----
24  豉汁蒸鱼	200g	200g	80%	
	300g	300g		
	400g	400g		
	500g	500g		
	600g	600g		
25  麻婆豆腐	200g	200g		
	300g	300g		
	400g	400g		
	500g	500g		
600g	600g			
26  快速解冻	100-2000g	100g-2.0kg	----	解冻过程中，蜂鸣器会响起，提醒您将食物翻面。
27  黄油软化	100g	100g	10%	----
28 发酵	5 秒 -12 小时	5 秒 -12 小时	----	微波炉温度高于 60°C 时， 屏幕显示“F01”。
29  炉腔除味	5s-95min	5s-1h35min	----	运行微波炉的风扇，来去除微波炉异味。
30  微波杀菌	3min	3m00s	----	消毒前，请将器皿浸湿。



#### 注

使用带微波功能的菜单时，可使用产品自带烤架，请勿放入空气炸篮及其他金属制品。

 指带微波功能菜单，请勿使用金属附件。

## 更多功能

### 10-1 豉汁蒸鱼 / 麻婆豆腐

- (1) 待机状态下，按一下“Auto Menu”键，屏幕显示“01”。
- (2) 旋转旋钮选择菜单 24/25。显示“24” / “25”。
- (3) 按“ $\frac{\text{Confirm}}{\text{Start}}$ ”键确认。
- (4) 旋转旋钮设置重量。
- (5) 按“ $\frac{\text{Confirm}}{\text{Start}}$ ”键开始烹饪。

### 10-2 快速解冻

- (1) 待机状态下，按一下“Auto Menu”键，屏幕显示“01”。
- (2) 旋转旋钮选择菜单 26。显示“26”。
- (3) 按“ $\frac{\text{Confirm}}{\text{Start}}$ ”确认菜单。
- (4) 旋转旋钮设置重量。重量范围在 100g 至 2.0kg 之间。
- (5) 按“ $\frac{\text{Confirm}}{\text{Start}}$ ”键开始烹饪。

#### ● 注

解冻过程中，蜂鸣器会响起，提醒您将食物翻面。

如果没有操作，微波炉将继续工作。

### 10-3 黄油软化

- (1) 待机状态下，按一下“Auto Menu”键，屏幕显示“01”。
- (2) 旋转旋钮选择菜单 27。显示“27”。
- (3) 按“ $\frac{\text{Confirm}}{\text{Start}}$ ”确认菜单。
- (4) 旋转旋钮输入重量，显示默认重量“100g”。
- (5) 按“ $\frac{\text{Confirm}}{\text{Start}}$ ”键开始软化。

#### 10-4 发酵

- (1) 待机状态下，按一下“Auto Menu”键，屏幕显示“01”。
- (2) 旋转旋钮选择菜单 28。显示“28”。
- (3) 按“ $\frac{\text{Confirm}}{\text{Start}}$ ”确认菜单。
- (4) 旋转旋钮设置温度。温度范围在 25°C-45°C 之间。
- (5) 按“ $\frac{\text{Confirm}}{\text{Start}}$ ”键确认温度。
- (6) 旋转旋钮设置时间，最长时间为“12h00m”。
- (7) 按“ $\frac{\text{Confirm}}{\text{Start}}$ ”键开始烹饪。

#### 注

微波炉温度高于 60°C 时，屏幕显示“F01”。

#### 10-5 炉腔除味

- (1) 待机状态下，按一下“Auto Menu”键，屏幕显示“01”。
- (2) 旋转旋钮选择菜单 29。
- (3) 按“ $\frac{\text{Confirm}}{\text{Start}}$ ”键确认。
- (4) 旋转旋钮设置时间，最长时间为“1h35m”。
- (5) 按“ $\frac{\text{Confirm}}{\text{Start}}$ ”键开始。

#### 注

微波炉将与风扇一起工作去除微波炉异味。

#### 10-6 微波杀菌

- (1) 待机状态下，按一下“Auto Menu”键，屏幕显示“01”。
- (2) 旋转旋钮选择菜单 30。
- (3) 按“ $\frac{\text{Confirm}}{\text{Start}}$ ”确认模式。
- (4) 按“ $\frac{\text{Confirm}}{\text{Start}}$ ”键启动 3m00s。

#### 注

消毒前，请将器皿浸湿。

## 无线连接

### 连接网络

待机状态下，长按“<sup>Pause/</sup>Cancel”键3秒，直到听见提示音“哔”，显示屏上出现“AP”。如果出现故障，将显示“NO”，30秒后，微波炉将返回待机模式。

### 断开网络连接

长按“<sup>Pause/</sup>Cancel”键8秒，直到发出提示音“哔”，“--”显示几秒钟，如果已成功中断连接，屏幕将显示“8888”，3秒后返回待机状态。如果出现故障，将显示“FFFF”，3秒后返回待机状态。

# 应用程序设置与操作

## 快速入门指南

将您的设备连接到手机上的SmartHome应用程序

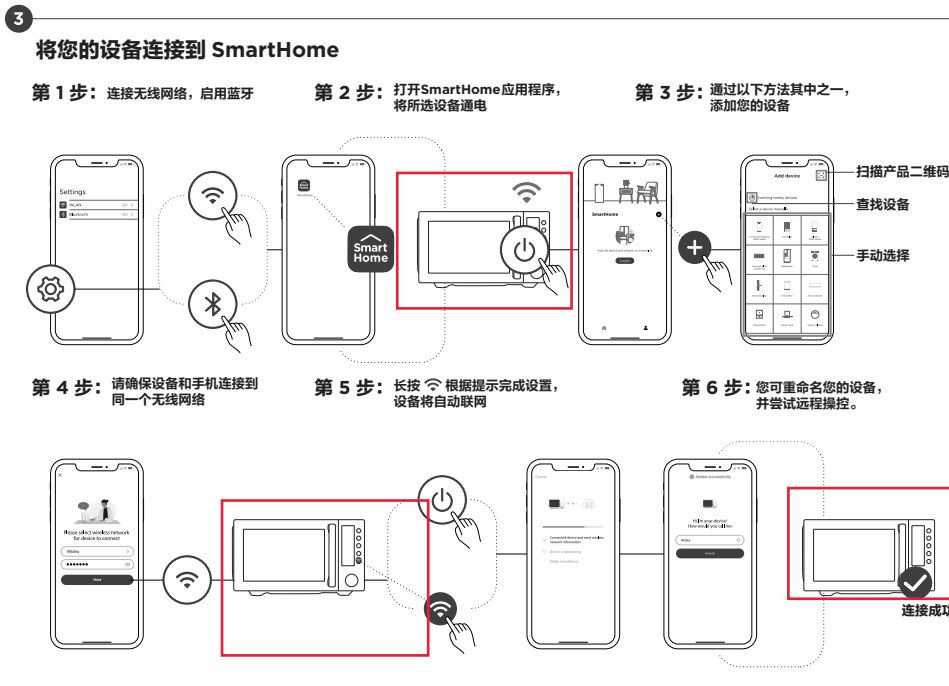

## 温馨提示

- 确保设备已通电。
- 联网时，请将手机靠近设备。
- 请将您的手机连接到家中的无线网络。
- 启用2.4GHz无线路由器。如果不确定路由器是否为2.4GHz，请联系生产厂家。
- 该设备无法与需认证的无线网络，及公共区域（如酒店、餐厅等）的网络连接
- 建议使用仅包含字母和数字的无线网络名称。如果您的无线网络名称包含特殊字符，请在路由器中修改。将设备连接网络时，停用WLAN+（安卓系统）或WLAN助手（iOS系统）
- 如需重新连接设备到无线网络，点击App主界面的“+”号，根据应用提示，按照类别和型号重新添加设备。

# 清洁和维护

确保断开本电器的电源。

- 使用后，用微湿的布清洁微波炉腔体。
- 按常规方法用肥皂水清洗配件。
- 门框、密封条和相邻部件脏污时，必须用湿布仔细清洁。
- 切勿使用粗糙的擦洗剂或锋利的金属刮刀来清洁微波炉门玻璃，因为它们会划伤表面，从而可能导致玻璃破碎。
- 清洁小贴士 --- 为了更容易地清洁烹饪食物可以接触到的炉腔壁：将半个柠檬放入碗中，加入 300 毫升（1/2 品脱）水，在 100% 微波功率下加热 10 分钟。再用柔软的干布将微波炉擦拭干净。

# 故障排除

正常	
微波炉工作时，	广播和电视接收可能会受到干扰，这与小型电器，如搅拌机、吸尘器和电风扇的干扰相似。 这是正常现象。
昏暗的微波炉灯光	在低功率下运行微波炉微波功能时，其光线可能变暗。这是正常现象。
蒸汽积聚在微波炉门上，热气从排气口排出。	烹饪时，食物可能会冒出蒸汽。通风口会排出大部分蒸汽。但有些会积聚在微波炉门等低温位置。这是正常现象。
微波炉在没有食物的情况下意外启动。	<b>禁止微波炉空载运行，此操作相当危险。</b>

故障	可能原因	补救措施
微波炉无法运行。	(1) 电源线未插紧。	拔下电源线。10 秒钟后再次插入插头。
	(2) 保险丝熔断或断路器工作。	更换保险丝或复位断路器（由我公司专业人员维修）
	(3) 插座故障。	用其他电器测试插座。
微波炉不加热。	(4) 门未关好。	关好炉门。



根据报废的电气电子设备（WEEE）指令，应单独收集和处理 WEEE。如果您在未来任何时候需要处理本产品，请不要将本产品与生活垃圾一起处理。请将本产品送至 WEEE 收集点（如有）。

# 商标、版权和法律声明

 Midea 标识、文字标记、商业名称、商业外观及其所有版本均为美的集团和 / 或其关联公司（【美的】）的宝贵资产，美的拥有商标权、版权和其他知识产权，以及因使用美的商标的任何部分而产生的所有商誉。未经美的事先书面同意，将美的商标用于商业目的，可能构成商标侵权或违反不正当竞争相关法律的规定。

本手册由美的编制，版权归美的所有。未经美的事先书面同意，任何单位和个人不得使用、复制、修改、分发本手册的全部或部分内容，也不得与其他产品捆绑或销售。

印刷本手册时，所有描述的功能和说明均为最新功能和说明。但由于功能和设计的改进，实际产品可能会有所不同。



# 数据保护公告

提供与客户约定的服务时，我们同意与向客户提供服务的约定国家保持一致，不受限制地遵守适用数据保护法的所有规定。

一般而言，我们进行数据处理通常是为了履行与您所签订合同项下的义务，并出于产品安全的原因，保障您在保修和产品注册问题上的权利。在某些情况下，只有在保证提供适当数据保护之时，才可能向欧洲经济区外的接收方传输个人数据。

如有要求，可提供更多信息。您可以通过 **MideaDPO@midea.com** 联系我们的数据保护专员。如需行使您的权利，如反对以直接营销为目的处理您的个人数据，请通过 **MideaDPO@midea.com** 联系我们。更多信息，请扫码关注。







*make yourself at home*



[www.midea.com](http://www.midea.com)

© Midea 2024 all rights reserved