

EASY SAUTE MULTI-COOKER

USER MANUAL

MPC5016AASS

Warning notices: Before using this product, please read this manual carefully and keep it for future reference. The design and specifications are subject to change without prior notice for product improvement. Consult with your dealer or manufacturer for details. The diagram above is just for reference. Please take the appearance of the actual product as the standard.

THANK YOU LETTER

Thank you for choosing Midea! Before using your new Midea product, please read this manual thoroughly to ensure that you know how to operate the features and functions that your new appliance offers in a safe way.

CONTENTS

THANK YOU LETTER	01
SAFETY INSTRUCTIONS	02
SPECIFICATIONS	06
PRODUCT OVERVIEW	07
SAFETY PRECAUTIONS	15
CLEANING AND MAINTENANCE	20
TROUBLESHOOTING	21
TRADEMARKS, COPYRIGHTS AND LEGAL STATEMENT	23
DATA PROTECTION NOTICE	24
1 YEAR LIMITED WARRANTY	25

SAFETY INSTRUCTIONS

Intended Use

The following safety guidelines are intended to prevent unforeseen risks or damage from unsafe or incorrect operation of the appliance. Please check the packaging and appliance on arrival to make sure everything is intact to ensure safe operation. If you find any damage, please contact the retailer or dealer. Please note modifications or alterations to the appliance are not allowed for your safety concern. Unintended use may cause hazards and loss of warranty claims.

Explanation of Symbols



Danger

This symbol indicates that there are dangers to the life and health of persons due to extremely flammable gas.



Warning of electrical voltage

This symbol indicates that there is a danger to life and health of persons due to voltage.



Warning

The signal word indicates a hazard with a medium level of risk which, if not avoided, may result in death or serious injury.



Caution

The signal word indicates a hazard with a low degree of risk which, if not avoided, may result in minor or moderate injury.



Attention

The signal word indicates important information (e.g. damage to property), but not danger.



Observe instructions

This symbol indicates that a service technician should only operate and maintain this appliance in accordance with the operating instructions.

Read these operating instructions carefully and attentively before using/commissioning the unit and keep them in the immediate vicinity of the installation site or unit for later use!

IMPORTANT PRECAUTIONS

CAUTION

- READ ALL INSTRUCTIONS.
- Do not touch hot surfaces. Only use side handles or knobs for carrying or moving.
- To protect against electrical shock, do not immerse the power cord, plugs, or appliance in water or other liquid.
- Close supervision is necessary when the appliance is used by or near children.
- Unplug from outlet when not in use and before cleaning. Allow to cool before putting on or taking off parts.
- Do not operate any appliance with a damaged cord or plug, or after the appliance malfunctions or has been damaged in any manner. Return appliance to the nearest authorized service facility for examination, repair, or adjustment.
- The use of accessory attachments not recommended by the appliance manufacturer may cause injuries.
- For household use only. Do not use outdoors.
- Do not let power cord hang over edge of table or counter, or touch hot surfaces.
- Do not place the appliance on or near a hot gas or electric burner, or a heated oven;
- Extreme caution must be used when moving the appliance containing hot liquids.
- Always attach plug to appliance first, then plug cord into the wall outlet.
- To disconnect, turn appliance “off”, then remove plug from wall outlet.
- Do not use appliance for anything other than intended use.
- This appliance cooks under pressure. Improper use may result in scalding injury. Make certain unit is properly closed before operating. Please see the “Getting Started” section.

- Do not fill the appliance over 2/3 full. When cooking foods that expand during cooking such as rice or dried vegetables, do not fill the appliance over 1/2 full. Over filling may cause a risk of clogging the vent pipe and developing excess pressure. See the “Prepare For Cooking” section.
- Do not open the appliance until the appliance has cooled and all internal pressure has been released. If the float valve is still up and/or the lid is difficult to open, this indicates that the appliance is still pressurized - do not force it open. Any pressure in the appliance can be hazardous. Please see the "Safely Open the Lid" section for instructions to safely remove lid.
- Always check the pressure release devices for clogging before use.
- Do not use this appliance for pressure frying with oil.
- To prevent risk of explosion and injury, replace only dynamic Pressure Seal as recommended by the manufacturer. See operating Instructions.
- Intended for countertop use only.
- **WARNING:** Spilled food can cause serious burns. Keep appliance and cord away from children. Never drape cord over edge of counter, never use outlet below counter, and never use with an extension cord.
- **CAUTION:** Risk of electric shock. Cook only in removable container.
- This appliance is not intended for deep frying foods.
- This appliance has a polarized plug (one blade is wider than the other). To reduce the risk of electric shock, this plug is intended to fit into a polarized outlet only one way. If the plug does not fit fully into the outlet, reverse the plug. If it still does not fit, contact a qualified electrician. Do not attempt to modify the plug in any way.

⚠ WARNING

🕒 Observe instructions

- If the supply cord is damaged, it must be replaced by the manufacturer, its service agent or similarly qualified persons in order to avoid a hazard.
- The appliance is not intended to be operated by means of an external timer or a separate remote-control system.
- Do not tamper with any of the safety systems beyond the maintenance instructions specified in the instructions for use.
- Only use manufacturer's spare parts in accordance with the relevant model. In particular, use a body and a lid from the same manufacturer indicated as being compatible.
- Be aware that certain foods, such as applesauce, cranberries, pearl barley, oatmeal or other cereals, split peas, noodles, macaroni, rhubarb, or spaghetti can foam, froth, and sputter, and clog the pressure release device (steam vent). These foods should not be cooked in a pressure cooker.
- When the normal operating pressure is reached, turn the heat down so all the liquid, which creates the steam, does not evaporate.

PLEASE SAVE THESE INSTRUCTIONS

SPECIFICATIONS

Product Model	MPC5016AASS
Volume	5Qt
Power Supply	120V-
Rated Power	1000W
Frequency	60Hz
Working Pressure	70kPa
Keep Warm Temperature	140° F-176° F

PRODUCT OVERVIEW

Product Structure

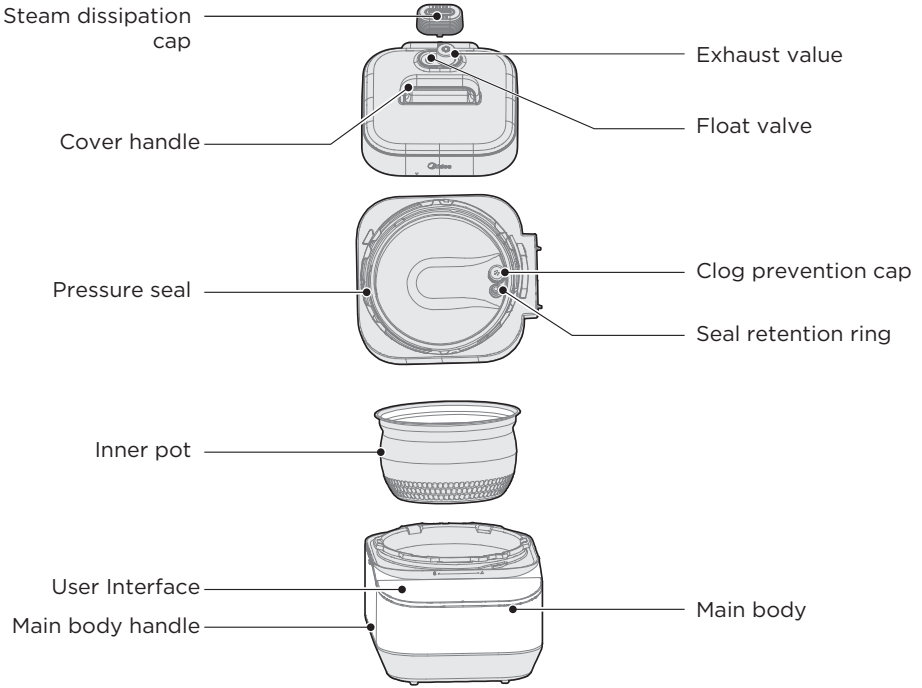

Parts List



Flat spoon



Ladle



User Manual



Measuring cup

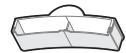

Drip tray

NOTE

All the pictures in this manual are for explanation purpose only. Any discrepancy between the real object and the illustration in the drawing shall be subject to the real subject.

User Interface

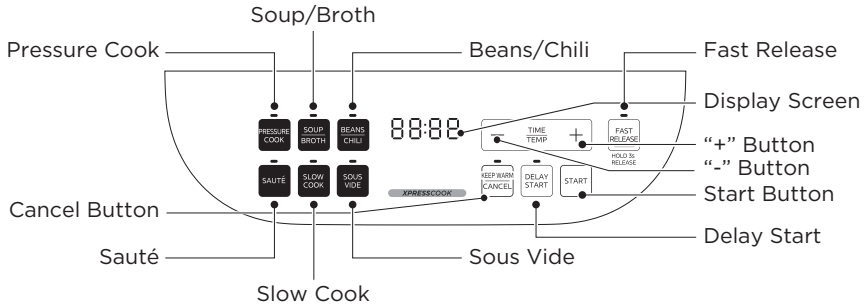

Operation Guidelines

Function	Operation Guidelines
KEEP WARM/- CANCEL	<ul style="list-style-type: none"> Cancel the current state, return to standby or enter keep warm state.
FAST RELEASE	<ul style="list-style-type: none"> At any time (standby, cooking, or cooking complete state), the "FAST RELEASE" button can be tapped to switch an automatic fast or natural release. If automatic fast release is set, the LED above the button will be lit up. If natural release is set, the LED above the button will be off. When fast release is set (by tapping "Misspelled RELEASE" button) the 7-segment display will show "FAST". When natural release is set (by tapping "FSAT RELEASE" button) the 7-segment display will scroll the word "NAtUrAL". Lastly, if fast release is set during the "cooking complete state" the steam will be released instantly. At any time (standby, cooking, or cooking complete state), the "FAST RELEASE" button can be held for 3s to instantly release the steam. The word "HOLD 3s RELEASE" is printed below the "FAST RELEASE" button. To stop releasing steam, "FAST RELEASE" can be held for 3s again.
TEMP/TIME	<ul style="list-style-type: none"> With temperature adjustable menu, you can press this button to switch between temperature and time adjustment.

Function	Operation Guidelines
DELAY START	<ul style="list-style-type: none"> • Delay Start: Before the program start, press “DELAY START” button. • The screen shows the preset beginning time. Press “-” or “+” or “DELAY START” button to adjust the delay time. Press “START” button, the unit starts delay time count down. When it count-down to the end, the program starts working. • Note: SAUTÉ/SOUS VIDE function cannot set the delay timer.
PRESSURE COOK/ SOUP/BROTH/ BEANS/CHILI	<ul style="list-style-type: none"> • In standby mode, press “PRESSURE COOK”, “SOUP/BROTH”, “ BEANS/CHILI”button, the indicator light is on and the digital screen shows default working time. Press “+” or “-” button to adjust the working time. Press “START” button to enter into cooking state. • The digital screen starts countdown as soon as the pressure rises to working pressure. Auto release and enters into keep warm when it finishes working.
SAUTÉ	<ul style="list-style-type: none"> • In standby mode, press “SAUTÉ” button, the indicator light is on and the digital screen shows default working time. Press “+” or “-” button to adjust the working time. Press “TEMP/TIME” button, then press “+” or “-” button to adjust the working temperature. Press “START” button to enter into cooking state. Starts countdown and enters to standby state when it finishes working.
SLOW COOK	<ul style="list-style-type: none"> • In standby mode, press “SLOW COOK” button, the indicator light is on and the digital screen shows default working time. Press “+” or “-” button to adjust the working time. Press “START” button to enter into cooking state. Starts countdown and enters into keep warm when it finishes working.
SOUS VIDE	<ul style="list-style-type: none"> • In standby mode, press “SAUTÉ” button, the indicator light is on and the digital screen shows default working time. Press “+” or “-” button to adjust the working time. Press “TEMP/TIME” button, then press “+” or “-” button to adjust the working temperature. Press “START” button to enter into cooking state. The digital screen starts countdown as soon as the pressure rises to working temperature. Enters to standby state when it finishes working.
“+ -”	<ul style="list-style-type: none"> • In standby mode, press “+” and “-” for 3 seconds at the same time to switch the temperature unit between °C and °F. The temperature unit will be displayed on the digital screen.

● Tips:

1. Please move the product with the handle of the main body;
2. Please remove the water from the housing cover with cloth.

● NOTE

- Exhaust valve: Pull out the exhaust valve from the lid. Clean the internal side of the exhaust valve and the exhaust valve and float valve of the lid with brush and cloth at least once a month.
- Pressure seal: Please remove oil and dirt from the sealing ring with detergent and brush.
- Drip tray: After cooking, the steam may stay in the drip tray of the external pot as water. Water in the box should be removed for avoiding bad odor, please clean it with clean cloth.

Disassemble and Install the Clog Prevention Cap, Pressure Seal and Sealing ring

Disassemble and install the Clog Prevention Cap

1. Check if the pressure seal and clog prevention cap cover are correctly installed in the cover handle cover before use each time.
2. After use, please clean the pressure seal and around of clog prevention cap for avoiding jamming the cover, keep it clean to avoid bad odor.

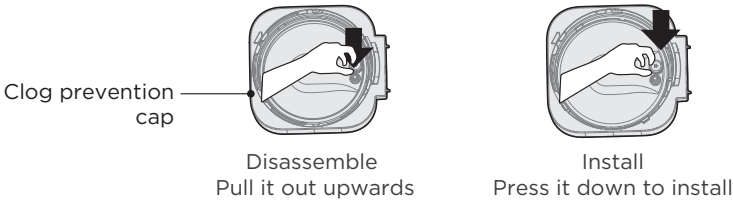

Disassemble and install the pressure seal

1. Please do not pull the pressure seal, otherwise, the distorted pressure seal may influence the seal and pressure effect.
2. Do not use the damaged pressure seal, please replace it at the authorized repair office.

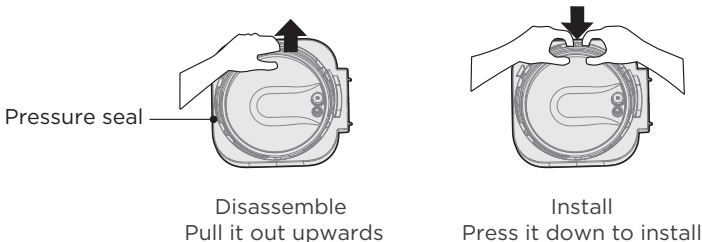

Disassemble and install the sealing ring

1. Please do not pull the sealing ring, otherwise, the distorted pressure seal may influence the seal and pressure effect.
2. install the sealing ring, When the float valve is in a falling state, press the self-locking component with the left hand, then rotate the lid with left hand and press the sealing ring with right hand.

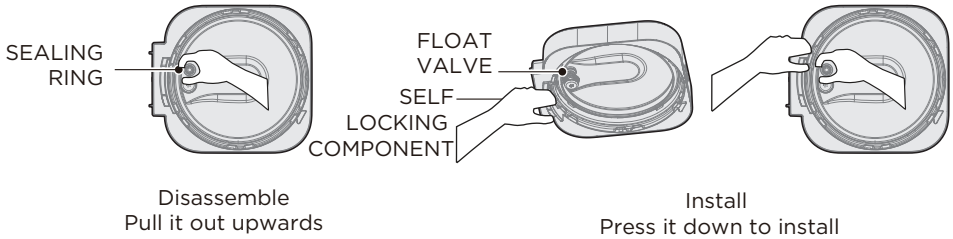

Use and Maintain the Inner Pot

1. Do not empty

It may cause yellowish and spotted inner pot or distorted bottom if it is empty for a long time.

2. Do not use it to store the acid, alkali and preserved foods for a long period

Although the inner pot has excellent anti-corrosion performance, it may cause corrosion of certain degree, the suggested time of keep warm shall not exceed 2h.

3. Keep it clean to prolong the service life

Do not immerse it in water for a long period.

Clean the inner pot with soap, mild detergent or warm water to remove dust, oil and dirt.

4. Do not use a metal shovel or other hard tool, otherwise it will damage the inner surface of pot.

Prepare for Cooking

1 Opening the lid correctly

- Hold the handle of cover handle cover, turn it anticlockwise for about 30° till the lid at unlock state, and then lift the cover handle cover.



Unlock State

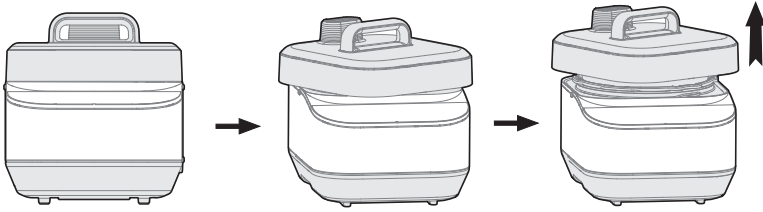

2 Check if the parts and accessories of lid are well installed

- Check if the floater valve and exhaust valve are jammed, confirm if the sealing ring and clog prevention cap are well installed.

3 Take out the inner pot, put the foods and water into the inner pot

- The total amount of foods and water shall not exceed the Max marked on the inner pot.

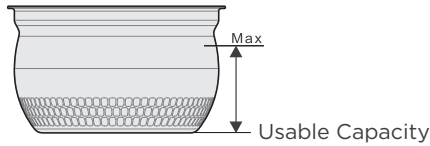

4 Put the inner pot into the cooker

- Wipe to clean the external surface of inner pot, foreign object and water are not allowed on the inner surface of electric pressure cooker;
- Turn the inner pot to left and right to ensure good contact with the heating plate.

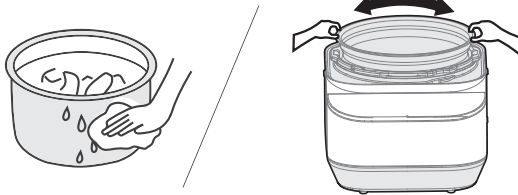

5 Safely close the lid

- Before closing the lid, check if the sealing ring is well installed.
- Hold the handle of cover handle cover, aim the lid as “unlock state”, put the top cover horizontally on the main body, turn the cover handle cover clockwise for about 30° to the lock place as “Lock State”.

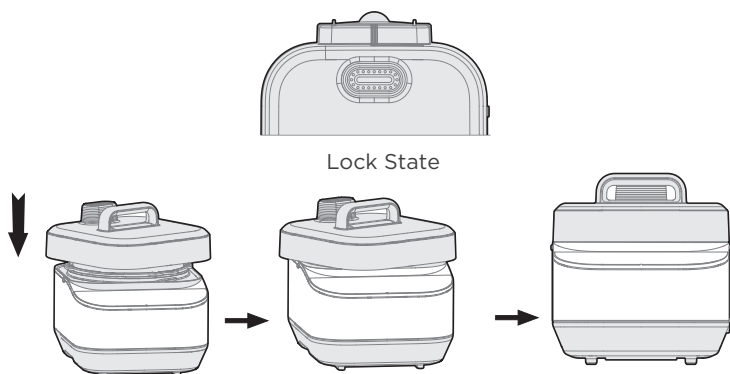

6 Put the exhaust valve well

- When working, please turn the exhaust valve to the sealing place, which means the electric pressure cooker keeps at sealing state;
- For manual exhaust, please turn the exhaust valve handle to the exhaust place, the electric pressure cooker keeps at the exhaust state; when exhausting, do not keep the hands or face above the exhaust opening;

NOTE

- (Picture are for reference only, actual product may differ from picture shown)
- Check if the floater valve drops down before working (before heating, the floater valve is down).

General Function

1. Switch on If the buttons are inactive when use, please confirm if the lid is closed at the right place, the buttons are inactive if the lid is not closed correctly for product of this series.
2. After cooking, the cooker may automatically enter into the keep warm state. After cooking, the cooker may automatically enter into the keep warm state (Some function). and the indicator display "0H(0 hour), 1H(1 hour), 2H(2 hour)..." or "LO:00(0 min), LO:01(1 min)...."

Tips:

When the cooker is working, it is normal that it makes "cluck" sound, please set your heart at relax when use.

To cook a small amount of foods, the inner pot may possibly be lifted when opening the lid, please shake the lid to drop the inner pot in the main body and then remove the lid.

Safely Open the Lid

1. Cut off power supply or remove the power plug
2. Open the lid

When the float valve drops, Turn the cover handle cover counter-clockwise to the open position, lift the cover handle cover.

Do not open the lid before the pressure in the pot has been completely released, do not open the cover with force if it is difficult to open.









When turning the exhaust valve, do not pull the valve off the cover.

After cooking fluid foods (porridge and soup), do not turn the exhaust valve or press the steam release button. Please disconnect the power supply and allow the cooker to cool naturally till the float drops before opening the lid.



SAFETY PRECAUTIONS

To avoid personal injury and property loss, be sure to observe the following safety precautions.

• Meanings of the marks:

 Means "Forbidden" items	 General Forbid	 Disassemble Forbidden	 Wet hands Forbidden
	 Contact Forbidden	 Spray Water Forbidden	
 Means "Mandatory" items	 Must be executed	 Remove the power plug	

• The danger caused by mistaken use if following warnings are neglected includes to two grades.

	<p>WARNING</p> <p>It may possibly cause death or serious injury if the warning items are disobeyed.</p>
	<p>CAUTION</p> <p>It may cause physical injury or property damage if the caution items are disobeyed.</p>

WARNING

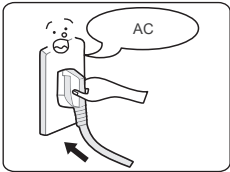

Use correct power outlet (Refer to the label)

- Failure to use correct electricity can cause fire or electric shock.
- Danger of fire if the bad socket is adopted.

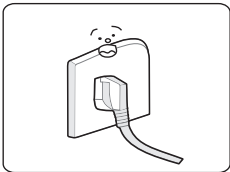

A socket shall be used alone

- A socket of more than 10A rated current with grounding wire shall be used alone;
- If shared with other electrical appliances, the socket may cause abnormal heat and result in fire.

WARNING

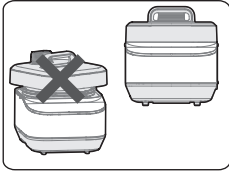

It is strictly prohibited to use other lid

- It is strictly prohibited to use other lid for heating, and in the (switching on) process, the use of non-original lid is not allowed.
- As this may cause electric shock or safety hazards.

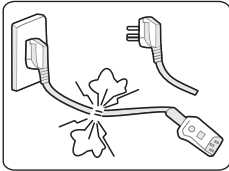

Stop using if the power cord is damaged

- Replace the damaged power cord with special soft cord or replace it with special assembly purchased from the manufacturer or authorized repair center.

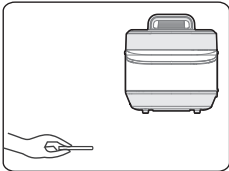

Do not put foreign objects

- It is prohibited to insert metal shavings, needles and other foreign matter in the gap.
- As this may cause electric shock or movement anomalies.

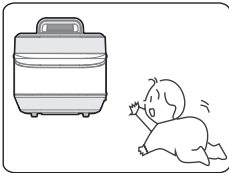

Place the appliance in a location out of reach of infants

- Place the appliance in a location out of reach of infants.
- To avoid electric shock and scald.

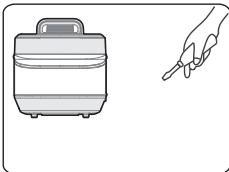

Modification is prohibited

- Modification or repair by non-professionals is prohibited.
- Violation may cause a fire or electric shock.
- Repair or replacement of parts shall be made in a designated service center.

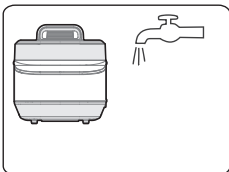

Products may not be immersed or sprinkled in water

- Doing so could cause electric shock and electrical short circuits.

⚠ WARNING



Warning on Opening the lid

- When the electric pressure cooker is not working, there isn't pressure in the pot, the float valve is down;
- When the electric pressure cooker is working, pressure in the cooker rises, float valve ascends; do not fiercely open the lid before the pressure has been completely released;
- If it is difficult to open the lid, please do not open it fiercely, otherwise, it may cause scalding or physical injury.

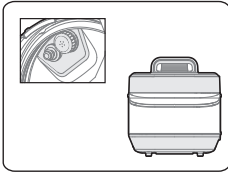

Check periodically

- Be sure to check periodically the clog prevention cap and exhaust valve core to make sure that they are not blocked;
- Do not cover the exhaust valve with heavy object or replace it with other object.

⚠ CAUTION

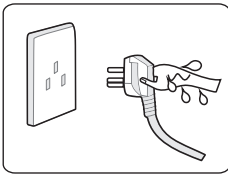

Never pull the plug with a wet hand

- To avoid electric shock.

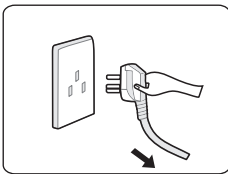

When pulling the plug, you must pinch the plug

- When pulling the plug, you must pinch the plug;
- Do not pull the power cord, otherwise it will damage the cord, causing electric shock and short circuit.

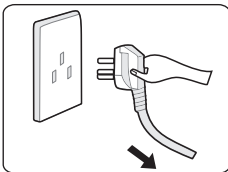

Unplugging when not in use

- Otherwise, it may produce leakage, fire or failure.

⚠ CAUTION

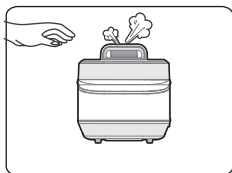

In working, never move your hands to close to the exhaust port.

- In cooking process, never move your hands to close to the exhaust port to avoid burns.
- During cooking, do not cover the vent with a cloth and other items.

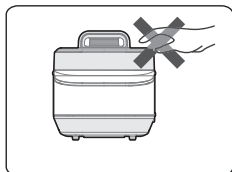

When the cooker is working, please do not touch the lid

- When the cooker is working, lid has high temperature, do not touch it;
- Otherwise, it may possibly cause scalding.

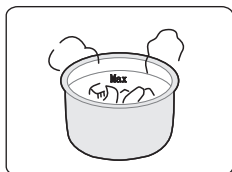

The total amount of food and water can not exceed Max scale

- The total amount of food and water can not exceed Max scale, otherwise food may be cooked unfamiliar, or cause malfunction.

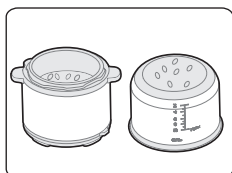

Do not use a pot other than the dedicated pot

- When there is foreign object on the bottom of pot and heating plate surface, remove the foreign object before use.
- Otherwise, it may cause overheating and work abnormalities etc.

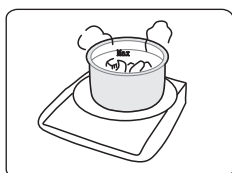

Do not put the inner pot on other appliance for heating

- In order to avoid deformation or fault.
- Please use the special inner pot.

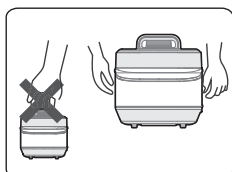

When moving the product, please hold the handle of main body

- When moving the product, do not directly hold the handle of lid for avoiding lid dropping.

CAUTION



Do not use in the following locations

- Do not use in unstable locations;
- Do not use in locations near water and fire;
- Do not use near walls and furniture;
- Do not use in locations exposed to direct sunlight and oil splatter.
- Do not approach the stove for avoiding fire.

Environment for Storing the Product

- Periodically clean the cooker and remove oil and dirt if it is stored on the table.
- Put the electric pressure cooker 12 inches away from other kitchen appliances.

CLEANING AND MAINTENANCE

1. Clean after each use.
2. Before cleaning and maintenance, please unplug the power cord until the product cools.
3. Remove the lid and inner pot, clean with detergent first, then rinse well with water, and wipe dry with a soft cloth.
4. Clean the internal side of the lid with water, the pressure seal, clog prevention cap, exhaust valve core and float valve can be removed for washing, timely and correctly install them after washing, and then dry the internal side of lid with cloth.
5. Wipe clean the cooker body with a rag, and it is prohibited to soak the cooker body in water or spray water to it.

TROUBLESHOOTING

Operation of your appliance can lead to errors and malfunctions. The following tables contain possible causes and notes for resolving an error message or malfunction. It is recommended to read the tables carefully below in order to save your time and money that may cost for calling to the service center.

S/N	Problem	Reason	Solution
1	Difficult to close the lid	• Sealing ring not installed properly.	• Position the sealing ring well.
		• The floater valve clamps the push rod.	• Lightly push the push rod.
2	Difficult to open the lid	• Float valve in the popped-up position.	• Press the float valve lightly with a Fine bamboo skewer.
		• Pressure exists inside the cooker.	• Open the lid after the pressure is completely released.
3	Steam leaks from the lid	• Sealing ring installed improperly.	• Install the sealing ring as required.
		• Food debris attached to the sealing ring.	• Clean the sealing ring.
		• Sealing ring damaged.	• Replace the sealing ring.
		• The lid is not closed correctly.	• Close the lid correctly.
4	Steam leaks from float valve.	• Food debris on the float valve gasket.	• Clean the float valve gasket.
		• Float valve gasket worn-out.	• Replace the float valve gasket.
5	Float valve unable to rise	• Too little food and water in inner pot.	• Add water and food according to the recipe.
		• Steam leaks from the lid or exhaust valve.	• Send to the service center for repair.

S/N	Problem	Reason	Solution	
6	Steam comes out from exhaust valve non-stop	• Exhaust valve not in sealing position.	• Turn the exhaust valve to the sealing position.	
		• Pressure control fails	• Send to the service center for repair.	
7	Power indicator doesn't light on	• Power socket bad contact.	• Please check the power socket.	
8	All indicators flas	Display screen displays E1	• Bottom sensor fault.	• Send to the service center for repair.
		Display screen displays E2		
		Display screen display EU	• Communication failure	• Re-plug. If the fault still exists, send it to the official authorized office for repair
		Display screen displays E8	• Pressure switch fault.	• Send to the service center for repair.
9	Rice half cooked or too hard	• Too little water.	• Add water accordingly.	
		• Lid opened prematurely.	• After cooking cycle completes, leave the lid on for 5 more minutes.	
10	Rice too soft	• Too much water.	• Reduce water accordingly.	

If followings occur	Solutions
<ul style="list-style-type: none"> • Power cord and plug is expanded, deformation, damaged and its color is changed. • One part of the power cord and plug are hotter. • Power cord is flexible with discontinuous power supply. • The electric pressure cooker has abnormal heating and generates bad odor. • There's abnormal noise or vibration when supply power. 	Stop using, and repair it by the authorized repair center.
<ul style="list-style-type: none"> • There's dust or dirt on the plug or socket. 	Remove the dust or dirt.

—If the fault is not removed after above check, please contact our authorized service center for repair.

TRADEMARKS, COPYRIGHTS AND LEGAL STATEMENT

 Midea logo, word marks, trade name, trade dress and all versions there of are valuable assets of Midea Group and/or its affiliates (“Midea”), to which Midea owns trademarks, copyrights and other intellectual property rights, and all goodwill derived from using any part of an Midea trademark. Use of Midea trademark for commercial purposes without the prior written consent of Midea may constitute trademark infringement or unfair competition in violation of relevant laws.

This manual is created by Midea and Midea reserves all copyrights thereof. No entity or individual may use, duplicate, modify, distribute in whole or in part this manual, or bundle or sell with other products without the prior written consent of Midea.

All the described functions and instructions were up to date at the time of printing this manual. However, the actual product may vary due to improved functions and designs.

DATA PROTECTION NOTICE

For the provision of the services agreed with the customer, we agree to comply without restriction with all stipulations of applicable data protection law, in line with agreed countries within which services to the customer will be delivered, as well as, where applicable, the EU General Data Protection Regulation (GDPR).

Generally, our data processing is to fulfil our obligation under contract with you and for product safety reasons, to safeguard your rights in connection with warranty and product registration questions. In some cases, but only if appropriate data protection is ensured, personal data might be transferred to recipients located outside of the European Economic Area.

Further information are provided on request. You can contact our Data Protection Officer via **MideaDPO@midea.com**. To exercise your rights such as right to object your personal data being processed for direct marketing purposes, please contact us via **MideaDPO@midea.com**. To find further information, please follow the QR Code.

1 YEAR LIMITED WARRANTY

This is the only express warranty for this product and is in lieu of any other warranty or condition. This product is warranted to be (1) year from the date of original purchase. During this period, your exclusive remedy is repair or replacement of this product or any component found to be defective, at our option; however, you are responsible for all costs associated with returning the product to us and our returning the product or component under this warranty to you. If the product or component is no longer available, we will replace with a similar one of equal or greater value. This warranty does not cover wear from normal use, and damages to the product resulting from accident, alteration, abuse, or misuse. This warranty extends only to the original consumer purchaser or gift recipient. Keep the original sales. This warranty is void if products is used for other than single family household use or subjected to any voltage and waveform. We exclude all claims for special, incidental, and consequential damages by breach of express or implied warranty. All liability is limited to amount of the purchase price. Every implied warranty, including any statutory warranty or condition of merchantability prohibited by law, in which case such warranty or condition is limited to the duration of this written warranty. Legal rights that vary depending on where you live. Some states or provinces do not allow limitations on implied warranties or special, incidental consequential damages, so the foregoing limitations may not apply to you. Please note that failure to complete and submit this form does not diminish your warranty.

In the event of a warranty period claim, question, comments or if service is required for this product, please contact us at the following:

customerserviceusa@midea.com
1-866-646-4332



make yourself at home



www.midea.com

© Midea 2022 all rights reserved